

P	LTR	DESCRIPTION	DATE	DWN	APVD
A		REVISED PER ECN-22-158649	13JUN2022	RZ	WK
AI		REVISED PER ECR-23-166709	28FEB2023	ED	WH

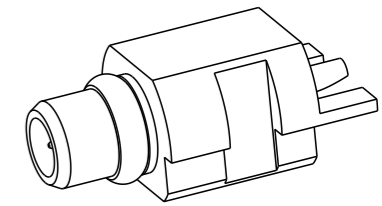
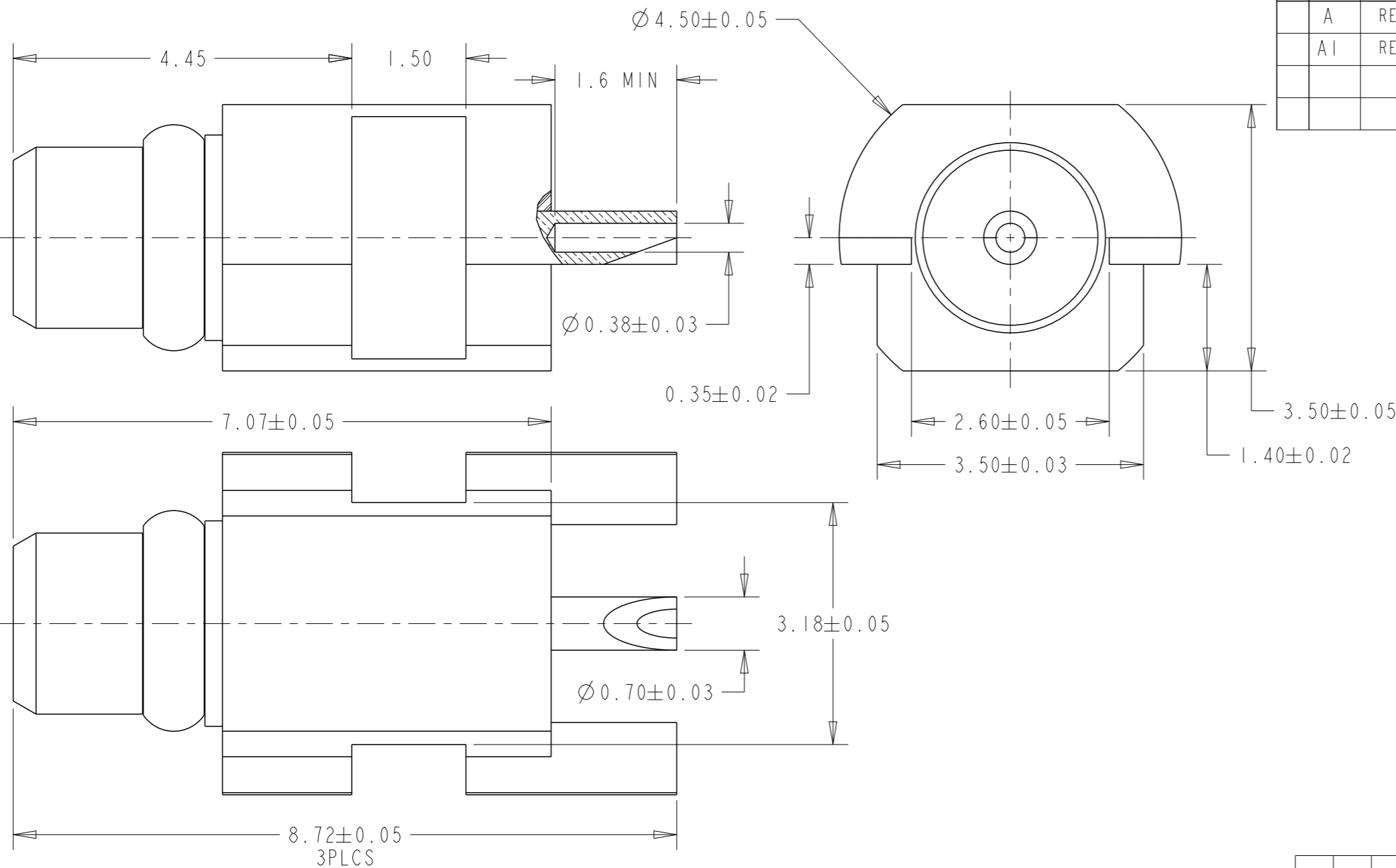

QTY REQD PER ASSY	REVISION OF EACH ASSY NO(WHEN BLANK, USE DWG REVISION)	PARTS LIST
1	Au 0.03um MIN	BeCu C-RING 4
1	/	PTFE INSULATOR 3
1	Au 0.03um MIN	BRASS CENTER CONTACT 2
1	Au 0.03um MIN	BRASS BODY 1
-1	PLATING	MATERIAL DESCRIPTION ITEM

ELECTRICAL	MECHANICAL	ENVIRONMENTAL
IMPEDANCE (OHM) 50	INTERFACE DIMENSION MIL-STD-348B BS 122340: 2002	TEMPERATURE RANGE -55°C TO +155°C
FREQUENCY RANGE (GHZ) DC TO 6	FORCE TO ENGAGE AND DISENGAGE ENGAGE 15N MAX DISENGAGE 6N MIN	THERMAL SHOCK MIL-STD-202, METH.107, COND.B
VOLTAGE RATING (PEAK) SEA LEVEL 170 VRMS	CENTER CONTACT CAPTIVATION AXIAL(N) 10 RADIAL(N.m) N/A	CORROSION MIL-STD-202, METH.101, COND.B
INSULATION RESISTANCE (MIN) 1000 MOHMS	CABLE RETENTION AXIAL(N) N/A RADIAL(N.m) N/A	VIBRATION MIL-STD-202, METH.204, COND.B
CONTACT RESISTANCE (MILLIOHMS MAX) CENTER CONTACT 5.0 OUTER CONTACT 2.0	MATING CYCLES 500 CYCLES MIN	SHOCK MIL-STD-202, METH.213, COND.A
DIELECTRIC WITHSTAND VOLTAGE (MIN) 500 VRMS		MOISTURE RESISTANCE MIL-STD-202, METH.106.
INSERTION LOSS 0.06*SQRT(F) dB		ROSH COMPLIANT
VSWR 1.25 Max		
RF LEAKAGE -60dB Min		

THIS DRAWING IS A CONTROLLED DOCUMENT.

DIMENSIONS:	TOLERANCES UNLESS OTHERWISE SPECIFIED:
mm	0 PLC ±-
	1 PLC ±0.5
	2 PLC ±0.13
	3 PLC ±0.013
	4 PLC ±0.0001
	ANGLES ±5
MATERIAL	FINISH
-	-
-	-

DWN	10SEP2019
RANDY Z	
CHK	10SEP2019
ERIC D	
APVD	10SEP2019
WENKE H	
PRODUCT SPEC	
APPLICATION SPEC	
WEIGHT	
CUSTOMER DRAWING	

STE TE Connectivity	
NAME MMCX PLUG ST FLUSH EDGE MOUNT RECEPTACLE	
SIZE	RESTRICTED TO
A3	-
CAGE CODE	
00779	
DRAWING NO	
C-2409307	
SCALE	SHEET
15:1	1 OF 1
REV	AI