

PRODUCT NUMBER
71959-YYXL^F

PLATING

WHEN REQUIRED, ADD SUFFIX LETTER "LF"
INDICATES THE PRODUCT IS ROHS
COMPATIBLE, SEE NOTE 7

3=0.76μm GOLD/GXT ON CONTACT AREA
3.81μm TIN-LEAD ON TAIL

4=3.81μm TIN-LEAD ON CONTACT AREA
AND ON TAIL

WHEN "LF" IS REQUIRED, 2μm MIN
MATTE TIN OVER 1.27μm MIN NICKEL
IS PROVIDED INSTEAD OF TIN-LEAD

STYLE	SIZE	OMIT PIN POSITION FROM TOP VIEW
01	1x03	1
02	1x03	2
03	1x03	3
04	1x07	3;4;5
05	1x04	2;3
06	1x04	1;2;
07	1x07	2;4;6

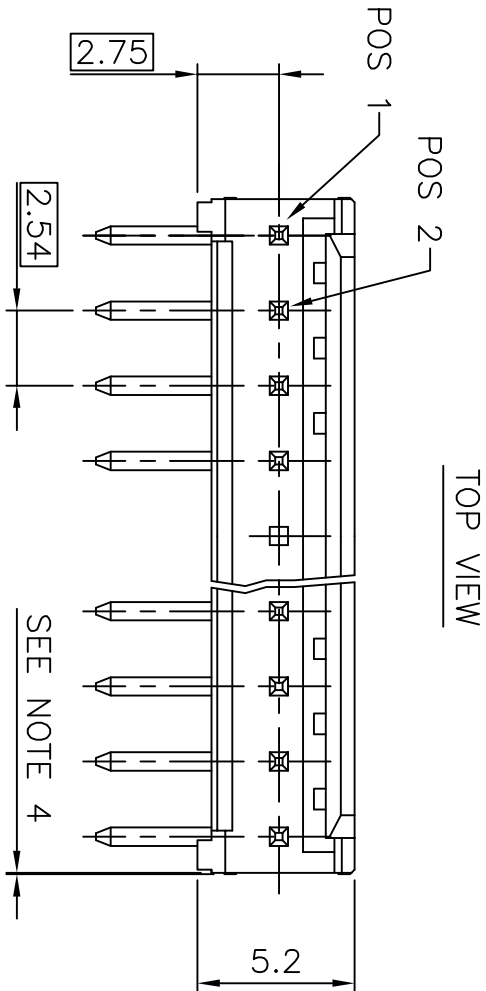

NOTES:

1. BODY MATERIAL: POLYESTER 30% GLASSFILLED COLOR BLUE, FLAME RETARDANT PER UL-94 V0.
2. CONTACT MATERIAL: PHOSPHOR BRONZE.
3. 15N MIN PIN RETENTION IN EITHER DIRECTION
4. 0.6 MAX PROTRUSION PERMITTED AT 4 PLACES
5. PACKAGING :
 - POLYBAGS FROM 02 TO 06 POSITIONS
 - TUBE FROM 07 TO 36 POSITIONS
6. TO DETERMINE DIMENSIONS :
N = NUMBER OF POSITIONS PER ROW
EXAMPLE : 8 POS N x 2.54 = 20.32mm
7. ROHS COMPATIBLE PRODUCT SPECIFICATIONS

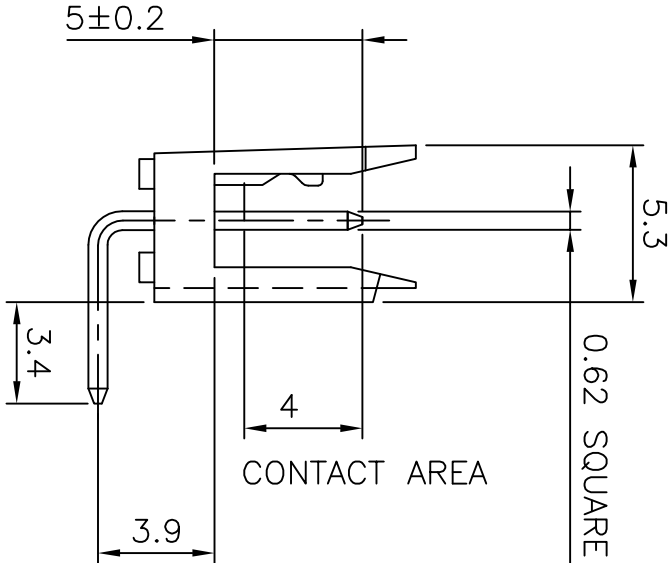

SOLDER AREA

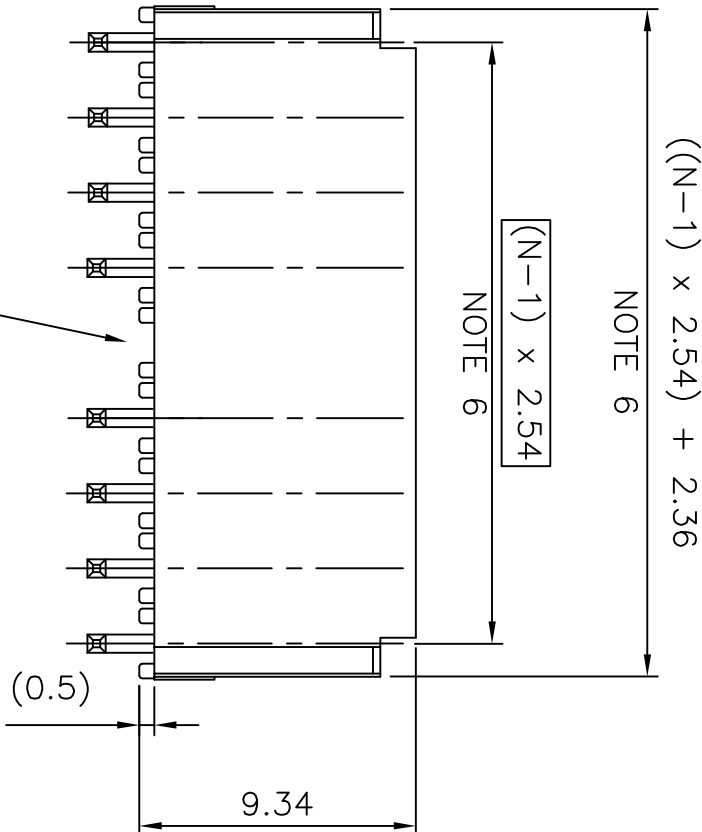

EXAMPLE OF
MISSING PIN

C

b - MANUFACTURING PROCESS COMPATIBILITY

- THE HOUSING WILL WITHSTAND EXPOSURE TO 245°C ±5°C SOLDER BATH TEMPERATURE FOR 5 SECONDS IN A WAVE SOLDER APPLICATION WITH A 1.6mm MIN THICK CIRCUIT BOARD.

c - LABELING:

- MEETS PACKAGING SPECS AS PER GS-14-920
- d - LEGAL STATEMENT: SEE GS-22-008

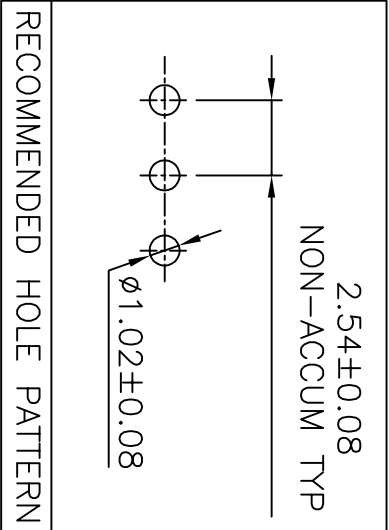

RECOMMENDED HOLE PATTERN

D



FCIconnect.com

Copyright FCI

Form: A3

1

2

3

4

5

D

1

2 3

4

5

6