

SAMZO REAC/ROHS

REV	ECN NO	DESCRIPTION	DESIGN	APPROVAL	DATE
A1	NEW	Replace frame			2013.06.21

- ◆ SPECIFICATIONS
- Current rating: 3A AC, DC
 - Voltage rating: 250V AC, DC
 - Temperature range: -25°C ~ +85°C
 - Insulation resistance: 1000MΩ Min.
 - Withstanding voltage: 1000V AC/ minute.
 - Contact resistance: 20mΩ Max.

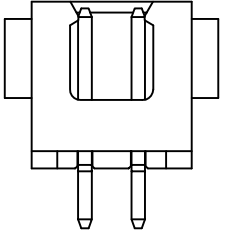
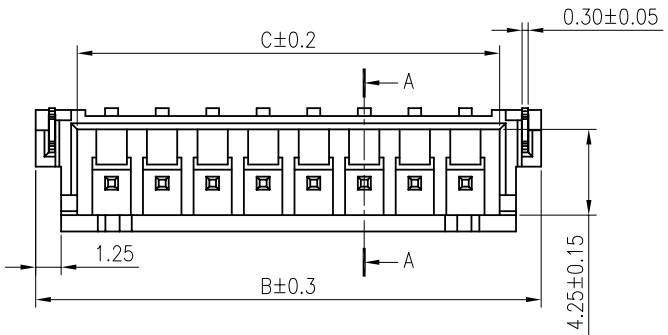

2 Circuits

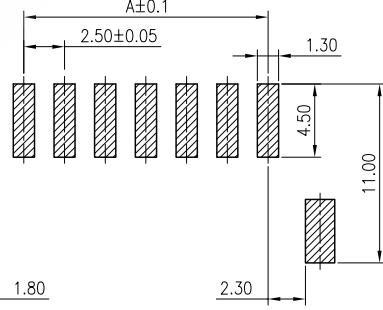
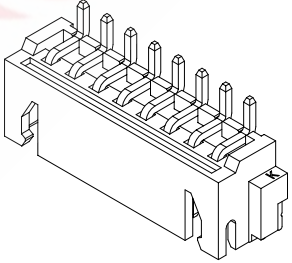
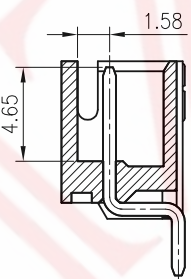
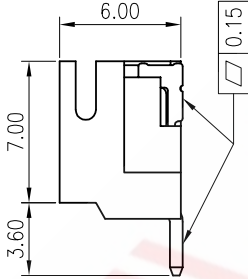
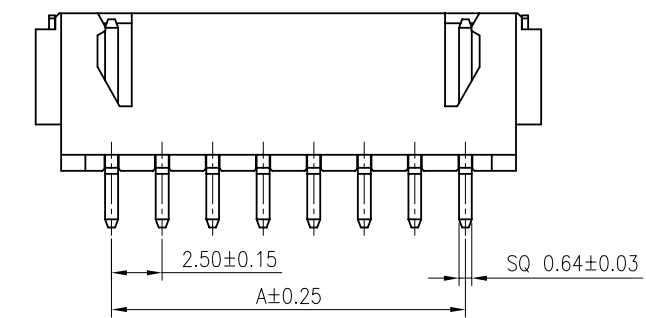

Recommended P.C.Board Layout

CKT.	Dimension		
	A	B	C
02	2.50	10.00	5.90
03	5.00	12.50	8.40
04	7.50	15.00	10.90
05	10.00	17.50	13.40
06	12.50	20.00	15.90
07	15.00	22.50	18.40
08	17.50	25.00	20.90
09	20.00	27.50	23.40
10	22.50	30.00	25.90
11	25.00	32.50	28.40
12	27.50	35.00	30.90
13	30.00	37.50	33.40
14	32.50	40.00	35.90
15	35.00	42.50	38.40
16	37.50	45.00	40.90

A. SERISE: 6L-XH
 B. SPACING: L-2.50mm
 C. MOUNTING: D-WT
 D. STANDARD: A-WAFER
 E: PIN: 02-2P (02-16P)
 F: CODE: 0-REGULAR

6LLDA0**

A B C D E F

ITEM	DESCRIPTION	MATERIAL	QTY	FINSH/COLOR			GENERAL TOLERANCE		
1	针脚	黄铜	N	镀锡			≥0~2<	±0.15	
2	主体	PA6T	1	米黄色			≥2~5<	±0.25	
3	定位片	黄铜	2	镀锡			≥0~2<	±0.15	
					DESIGN	WANGUIFA	2018.06.12	≥2~5<	±0.25
					CHECKED	ZHENGUILAN	2018.06.12	≥0~2<	±0.15
					APPROVED	LILIANJIANG	2018.06.14	≥5	±0.35

FIRST VIEW

SCALE 1:1 UNIT mm

The copyright belongs to samzo parts [China] Co., Ltd. please use the material after samzo parts agree to authorize. The final right of interpretation belongs to samzo parts. WWW.KKK-JP.COM

SAMZO COMPONENTS
 Electronic switch and connector manufacturer

TITLE: XH2.5-WT
 DWG NO: 6LLD-P2500
 PART NO: 6LLD25011
 MODEL NO: 6LLDA**-0
 NAME: WAFER CONNECTOR