

CLIFF

KMR Series Knobs

The KMR series are matt black, aluminium clad, plastic knobs with a domed top. They have a smooth powder coated finish. Standard colours are black or silver. Push fix only. The shaft size is 6mm splined with 18 teeth.

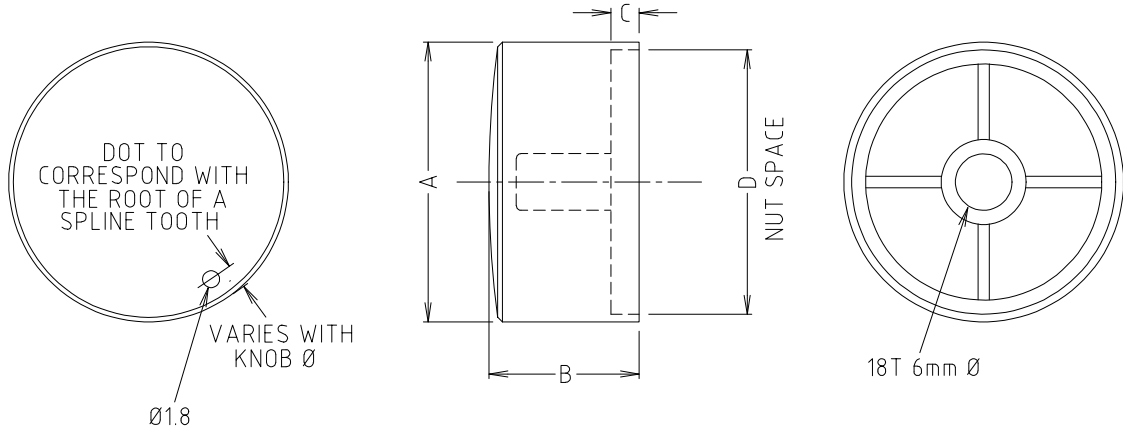

FC7229NML
KMR12B BLACK NO DOT



FC7230
KMR15 BLACK



FC7231
KMR20 BLACK



FC7232
KMR25 BLACK



FC72325
KMR25 SILVER



FC7233
KMR30 BLACK



FC7234
KMR35 BLACK

P/No.	MODEL	DIM A	DIM B	DIM C	DIM D	COLOUR	MARKER DOT
FC7229NML	KMR12B	12	13	1	10.7	BLACK	NO
FC7230	KMR15	14.8	15.6	2.2	13.0	BLACK	YES
FC7231	KMR20	19.8	17.6	4.0	18.0	BLACK	YES
FC7232	KMR25	24.8	18.4	-	23.1	BLACK	YES
FC72325	KMR25S	24.8	18.4	4.0	23.1	SILVER	YES
FC7233	KMR30	29.8	16.0	2.0	28.1	BLACK	YES
FC7234	KMR35	35.0	18.5	-	33.1	BLACK	YES