

61 KRMC

Screw terminal blocks, pitch 3.5/5.0/10.0 mm



Micro screw terminal block, clamp with wire protector,
upright version, consecutive placement without loss of
pitch
contact pitch 3.5 mm

Approvals:  

61 **KRMC**

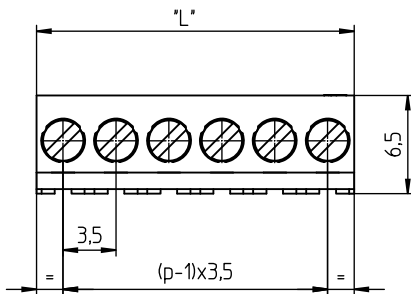
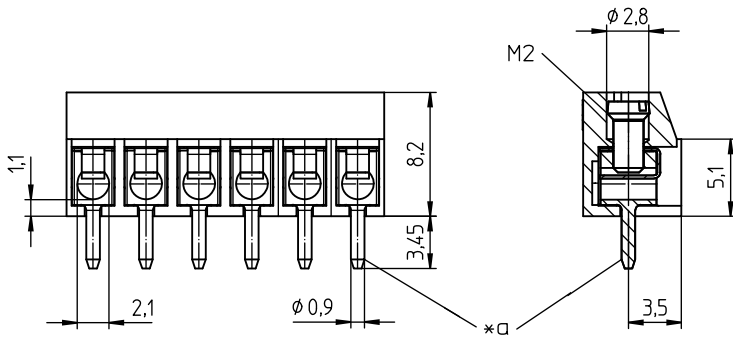

*a solder pin for printed circuit board bore hole \varnothing 1.3 mm

Environmental conditions

Temperature range -25 °C/+100 °C

Materials

Insulating body PA, V-2 according to UL94
Clamp CuZn, pre-nickel and tin-plated
Wire protector CuSn, pre-nickel and tin-plated
Screw steel, zinc-plated and chromated

Mechanical data

Screw size M2
Tightening torque screw 0,4 Nm

Connectable conductors for screw clamp

Section 0,05–1,5 mm² (VDE)
AWG 30–16 (UL), AWG 24–16 (CSA)
Stripping length 5.0 ± 0.5 mm

Electrical data (at T_{amb} 20 °C)

Rated current 6 A (T_{amb} 65 °C, UL)
Rated voltage 250 V AC (UL), 300 V (B, CSA)¹
Material group I (IEC)/0 (UL) (CTI ≥ 600)
Creepage distance 2,6 mm²
Clearance 2,6 mm²
Insulation resistance > 1 G Ω

¹ according to IEC 60664/DIN EN 60664, CTI UL classification according to ANSI/UL 746A

² with connected maximum cross section

61 **KRMC**

Designation	Pole Number	PU (Pieces)	MDQ (Pieces)	Dimensions L (mm)
KRMC 02	2	500	1000	7.0
KRMC 03	3	500	1000	10.5
KRMC 04	4	250	1000	14.0
KRMC 05	5	250	1000	17.5
KRMC 06	6	250	1000	21.0
KRMC 08	8	250	1000	28.0

Packaging:

in bulk, in a cardboard box