

SOLID-STATE TWO-WIRE TIME RELAY SETTING RANGE  
 0.5 S...10 S,  
 AC/DC 90...240 V, OFF-DELAY,  
 W. VARISTOR FOR MOUNTING ONTO CONTACTORS  
 SIZES00

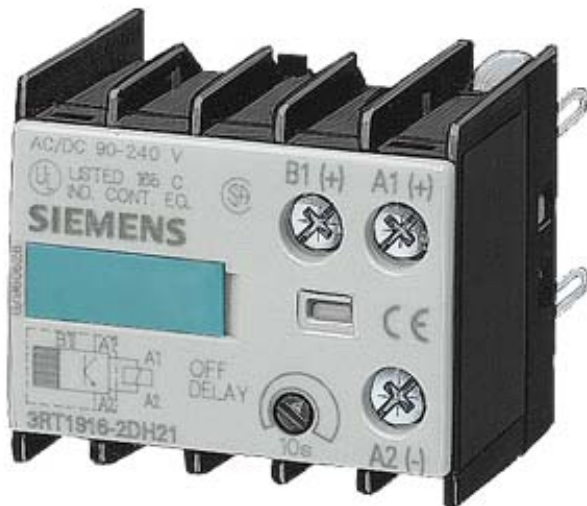

General technical data:		
product brand name		SIRIUS
product designation		timing relay
Design of the product		off-delayed with auxiliary voltage
type of voltage		AC
Size of the contactor / can be combined / company-specific		S00
Product function		
• star-delta circuit		No
• at the relay outputs / changeover delayed/without delay		No
Product component / semi-conductor output		Yes
Product extension / optional / remote control		No
Product extension / strictly required / remote control		No
Adjustable time	s	0.5 ... 10
Ambient temperature		
• during operating	°C	-25 ... +60
Item designation		
• according to DIN 40719 extendable after IEC 204-2 / according to IEC 750		K
• according to DIN EN 61346-2		K

**Switching Function:**

<b>Switching function</b>		
• slow-operating		No
• making pulse contact		No
• firmly clocked beginning with pulse		No
• firmly clocked beginning with pause		No
• relapse delayed		Yes
• variably clocked start with impulse		No
• impuls variably clocked start with pause		No
• with auxiliary voltage		
• in an additive way slow-operating		No
• temporary line fault		No
• relapse delayed		Yes
• without auxiliary voltage / relapse delayed		No

### Auxiliary circuit:

<b>Supply voltage frequency / for auxiliary and control current circuit</b>		
• rated value	Hz	50 ... 60
<b>Supply voltage / strictly required / auxiliary voltage</b>		Yes
<b>Control supply voltage</b>		
• at 50 Hz / at AC		
• rated value	V	90 ... 240
• at 60 Hz / at AC		
• rated value	V	90 ... 240

### Installation/mounting/dimensions:

<b>Width</b>	mm	45
<b>Height</b>	mm	38
<b>Depth</b>	mm	38

### Connections:

<b>Design of the electrical connection</b>		
• jumper socket		No
• for auxiliary and control current circuit		screw-type terminals

### Certificates/approvals:

<b>General Product Approval</b>	<b>EMC</b>	<b>Functional Safety / Safety of Machinery</b>
---------------------------------	------------	--



CCC



CSA



GOST



UL



C-TICK

[Type Examination](#)

**Declaration of Conformity**

**Test Certificates**



EG-Konf.

[Special Test Certificate](#)

**Shipping Approval**



ABS



BUREAU  
VERITAS



DNV



GL



LRS



PRS

**Shipping Approval**

**other**



RINA



RMRS

[Confirmation](#)

[Declaration of Conformity](#)

[other](#)

[Environmental Confirmations](#)

**Further information:**

**Information- and Downloadcenter (Catalogs, Brochures,...)**

<http://www.siemens.com/industrial-controls/catalogs>

**Industry Mall (Online ordering system)**

<http://www.siemens.com/industrial-controls/mall>

**CAX-Online-Generator**

<http://www.siemens.com/cax>

**Service&Support (Manuals, Certificates, Characteristics, FAQs,...)**

<http://support.automation.siemens.com/WW/view/en/3RT1916-2DH21/all>

**Image database (product images, 2D dimension drawings, 3D models, device circuit diagrams, ...)**

[http://www.automation.siemens.com/bilddb/cax\\_en.aspx?mlfb=3RT1916-2DH21](http://www.automation.siemens.com/bilddb/cax_en.aspx?mlfb=3RT1916-2DH21)

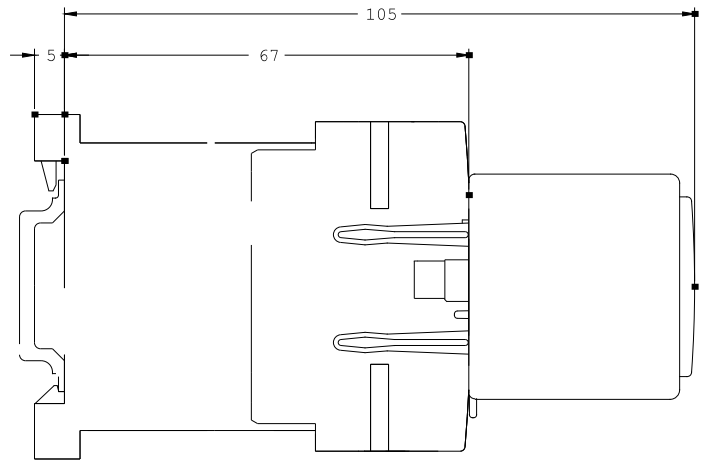
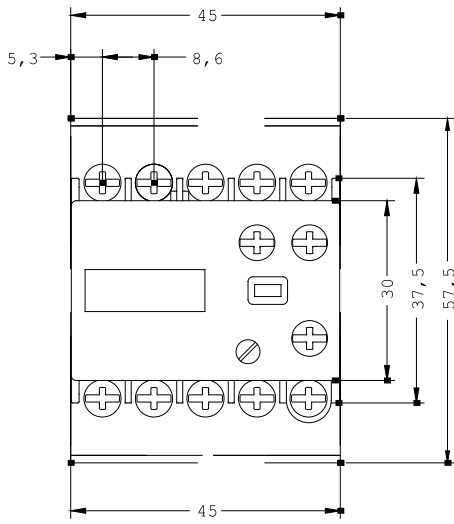

last change:

Feb 18, 2013