

P. C. B LAYOUT

**SPECIFICATIONS**

Current Rating: 3Amps  
 Insulator resistance: 5000 Megohms min.  
 Dielectric Withstanding: AC 500V  
 Operating Temperature: -40° C to +105° C  
 Insulator Material: PBT  
 Plating: Gold flash  
 Color: Black

UNSPECIFIED TOLERANCE: ±0.20

**Dimensions list**

Contacts Per row	Dimensions		Contacts Per row	Dimensions	
	A	B		A	B
6	5.08	15.22	30	35.56	45.7
8	7.62	17.76	32	38.1	48.24
10	10.16	20.3	34	40.64	50.78
12	12.7	22.84	36	43.18	53.32
14	15.24	25.38	38	45.72	55.86
16	17.78	27.92	40	48.26	58.4
18	20.32	30.46	42	50.8	60.94
20	22.86	33	44	53.34	63.48
22	25.4	35.54	46	55.88	66
24	27.94	38.08	48	58.42	68.56
26	30.48	40.62	50	60.96	71.1
28	33.02	43.16			

深圳市金航标电子有限公司

www.kinghelm.com.cn

**PH2.54\*8.9 180度 筒牛**

KH-2.54PH180-2X14P-L8.9

0755-28190160

Customer:

Approval:

Unit

Scale

Date

Drawing:

Check:

mm

05.03.05

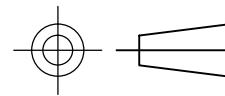

P/NO:

Pin Longer:

Signatuer: