



## PennEngineering Corporate Headquarters – Danboro, PA

5190 Old Easton Rd.

Danboro, PA 18916

**Phone:** 215-766-8853

**Toll-Free Phone:** 1-800-237-4736 (U.S. only)

**Email:** [info@pemnet.com](mailto:info@pemnet.com)

**Website:** [www.pemnet.com](http://www.pemnet.com)

### Part # MPP-2mm-10, PEM® Type MPP™ Self-clinching microPEM® Pins - Metric

PEM Type MPP, self-clinching microPEM® pins are ideal for today's compact electronic assemblies. Simply pressed into a properly sized mounting hole, these micro pins clinch permanently into place. They can be installed into a variety of sheet materials up to HRB 92/HB 195 in hardness and they offer excellent corrosion resistance.

#### Features and Benefits

- Satisfy demanding micro positioning and alignment applications.
- Head mounts flush into panels as thin as 0.5mm.
- Chamfered end makes mating hole

[+ more](#)

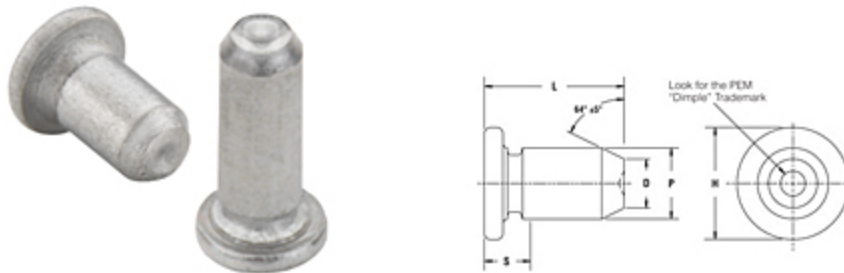

#### Specifications

<b>Pin Diameter P ± 0.038</b>	2.00 mm
	10 mm
<b>L - Length ± 0.15</b>	
<b>Min. Sheet Thickness</b>	0.50 mm
<b>Hole Size in Sheet + 0.025</b>	2.05 mm
<b>D ± 0.1</b>	1.36 mm
<b>H ± 0.25</b>	3.02 mm
<b>S Max.<sup>1</sup></b>	0.70 mm
<b>Min. Dist. Hole C/L to Edge</b>	4.40 mm

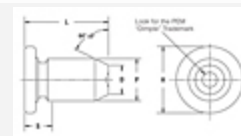

<b>Anvil Length</b>	13.18 mm
<b>For Use in Sheet Hardness<sup>2</sup></b>	HRB 92 / HB 195 or Less
<b>Fastener Material</b>	Age Hardened A286 Stainless Steel
<b>Standard Finish</b>	Passivated per ASTM A380 and/or tested
<b>CAD Supplier</b>	PennEngineering® (PEM®)

<sup>1</sup> Pin diameter may exceed max. in this region.

<sup>2</sup> HRB - Hardness Rockwell "B" Scale. HB - Hardness Brinell