

CUSTOMER

REV.	ECN NO.	DESCRIPTION	DATE	DESIGN

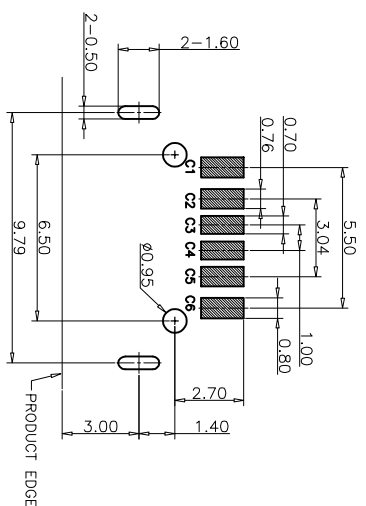

RECOMMEND P.C.B LAYOUT(COMPONENT SIDE)
TOLERANCE FOR PCB LAYOUT IS ±0.05

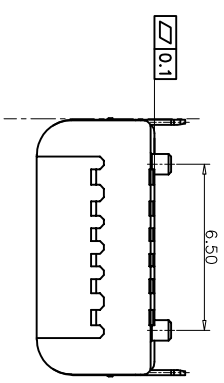
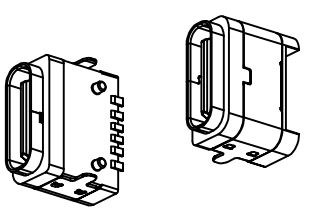
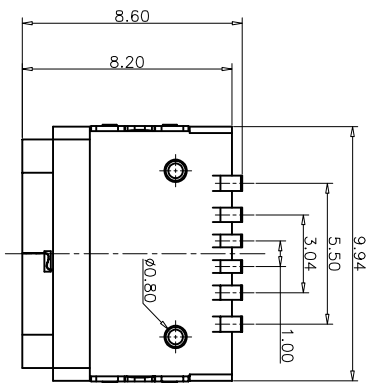
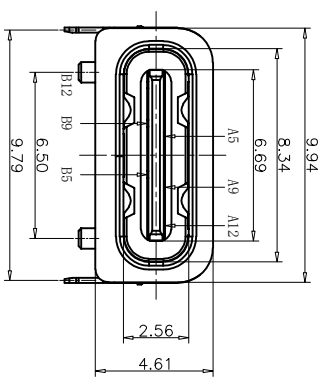
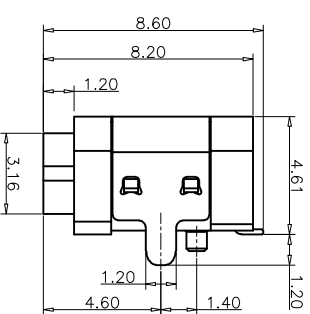
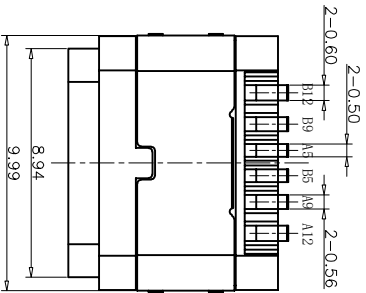

- NOTES:
SPECIFICATION:
1. CURRENT RATING: 3.0A MAX
2. VOLTAGE: 100 VAC
3. TEMPERATURE RANGE: -30°C~+85°C
4. CONTACT RESISTANCE: 40 MILLIONHM MAX
5. INSULATION RESISTANCE: 100 MEGOHMS MIN
6. INSERTION FORCE: 5N-20N
7. UNMATING FORCE: 8N-20N
8. DURABILITY: 10000 CYCLES
9. WATER PROOFNESS: THIS PRODUCTS BASED ON IPX7.

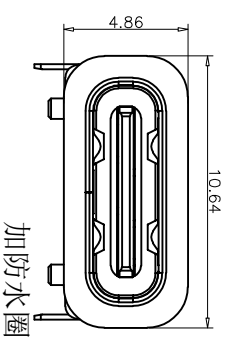

加防水圈示意图

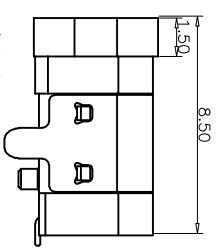

TABLE:

NO.	PART	QTY	Material
1	SHELL	1	STAINLESS STEEL,NI PLATED
2	CONTACT	6	COPPER STEEL,TIN/AU/NI PLATED
3	IND PLATE	1	STAINLESS STEEL,NO PLATING
4	1IND HOUSING	1	HIGH TEMPERATURE RESISTANT PLASTIC BLACK UL94 V-0
5	2IND HOUSING	1	HIGH TEMPERATURE RESISTANT PLASTIC BLACK UL94 V-0
6	SHIELDING PLATE	1	STAINLESS STEEL,NI PLATED

PIN ASSIGNMENT:

PIN NO	A1&B12	A4&B9	A5	B5	A9&B4	A12&B1
SIGNAL NAME	GND	VBUS	CC1	CC2	VBUS	GND
PCB PAD NO.	C1	C2	C3	C4	C5	C6

TOLERANCE	NAME(INTENDED USE)	CUSTOMER DRAWING
XX ±0.30	X.	±10'
.XX ±0.20	.X'	± 8'
.XXX ±0.10	.XX'	± 5'
UNITS	mm	
MATERILA	----	
FINISH	----	

PART NO.	NAME(INTENDED USE)	CUSTOMER DRAWING	TITLE:	DRWAG NO.
FY23-011TC61F182-Q2			CF 6P防水七级板上.两脚8. 2L	FY23-011TC61F182-02
DESIGN:	ZXM			
CHED:				
APPD:				

SCALE	SHEET	REV.
1:1	1/2	A