

# EV-T2MBIE12-3ACDC-INFRA - Vehicle Connector test adapter



1623492

<https://www.phoenixcontact.com/us/products/1623492>

Please be informed that the data shown in this PDF document is generated from our online catalog. Please find the complete data in the user documentation. Our general terms of use for downloads are valid.



CHARX connect, Vehicle Connector test adapter, Accessories, as a test adapter for charging station tests, CCS type 2, IEC 62196-3, 125 A / 850 V (DC), 20 A / 250 V (AC), length: 2 m, locking actuator: 12 V, 4-pos., Front and rear mounting

## Product description

Special Vehicle Inlet for charging station tests, solely for laboratory tests, tests with charging stations, and further analyses on the infrastructure side - not for installation in any type of vehicle, cannot be used outside of the laboratory area

## Commercial data

Item number	1623492
Packing unit	1 pc
Minimum order quantity	1 pc
Product key	XWBACD
GTIN	4055626172149
Weight per piece (including packing)	4,144 g
Weight per piece (excluding packing)	3,994 g
Country of origin	DE

# EV-T2MBIE12-3ACDC-INFRA - Vehicle Connector test adapter



1623492

<https://www.phoenixcontact.com/us/products/1623492>

## Technical data

### Product properties

Product type	Vehicle Connector test adapter
Product family	CHARX connect
Application	as a test adapter for charging station tests Combined Charging System
Type	Accessories
Charging standard	CCS type 2
Charging mode	Mode 2, 3, 4

### Electrical properties

Type of signal transmission	Pulse width modulation with modulated Powerline communication in accordance with ISO/IEC 15118 / DIN SPEC 70121
Note on the connection method	Crimp connection, cannot be disconnected
Insulation resistance	> 5 k $\Omega$
Temperature monitoring	2x Pt 1000
Type of charging current	AC 3-phase
Charging power	26.6 kW
Charging current	32 A
Type of charging current	DC
Charging power	106 kW
Charging current	125 A

### Power contact

Number	7 (L1, L2, L3, N, PE, DC+, DC-)
Rated voltage	250 V AC 850 V DC
Rated current	125 A DC 20 A AC

### Signal contact

Number	2 (CP, PP)
Rated voltage	30 V AC
Rated current	2 A

### Temperature sensors (Pt 1000)

Sensor type	Pt 1000
Standards/regulations	DIN EN 60751
Attachment point	2 sensors for the DC contacts
Switch-off temperature	90 °C $\pm$ 1 K (equivalent to a Pt 1000 value of 1346.5 $\Omega$ )
Long-term stability	0.06 % (after 1000 hours at 130 °C)
Recommended measured current	1 mA (1 V at 0°C)

# EV-T2MBIE12-3ACDC-INFRA - Vehicle Connector test adapter



1623492

<https://www.phoenixcontact.com/us/products/1623492>

Coefficient	3850 ppm/K
Ambient temperature	-50 °C ... 130 °C (Operation)

## Locking actuator

Operating voltage	12 V
Note number of positions	4-pos.
Position of the locking actuator	left-side

## Locking actuator

Operating voltage	12 V
Note number of positions	4-pos.
Position of the locking actuator	left-side
Possible power supply range at the motor	9 V ... 16 V
Maximum voltage for locking detection	30 V
Typical motor current for locking	0.2 A
Reverse current of the motor	max. 1 A
Max. dwell time with reverse current	1000 ms
Recommended adaptation time	600 ms
Pause time after entry or exit path	3 s
Service life insertion cycles	> 10000 load cycles
Lock recognition	available
Mechanical emergency release	available
Ambient temperature (operation)	-30 °C ... 50 °C
Cable length	0.5 m
Cable structure	4 x 0.5 mm <sup>2</sup>

## Dimensions

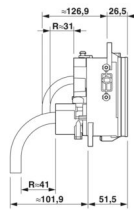
Dimensional drawing	
Bore dimensions	116 mm x 46 mm / 116 mm x 70 mm

## Cable/line

Cable length	2 m (AC cables)
	2 m (DC cables)
	0.5 m (Locking actuator cables)
Cable structure	2 x 35 mm <sup>2</sup> + 1 x 25 mm <sup>2</sup> + 2 x 2.5 mm <sup>2</sup> + 3 x 2 x 0.5 mm <sup>2</sup>
Cable length	2 m

## Mechanical properties

# EV-T2MBIE12-3ACDC-INFRA - Vehicle Connector test adapter



1623492

<https://www.phoenixcontact.com/us/products/1623492>

## Mechanical data

Insertion/withdrawal cycles	> 10000
Insertion force	< 100 N
Withdrawal force	< 100 N

## Environmental and real-life conditions

### Ambient conditions

Ambient temperature (operation)	-30 °C ... 50 °C
Ambient temperature (storage/transport)	-40 °C ... 80 °C
Altitude	5000 m (above sea level)

## Standards and regulations

### Standards

Standards/regulations	IEC 62196-3
-----------------------	-------------

## Mounting

Mounting type Vehicle charging inlet	Front and rear mounting (0 to 90 degree frontal inclination possible)
Mounting hole diameter	6.80 mm (ø)

# EV-T2MBIE12-3ACDC-INFRA - Vehicle Connector test adapter



1623492

<https://www.phoenixcontact.com/us/products/1623492>

## Drawings

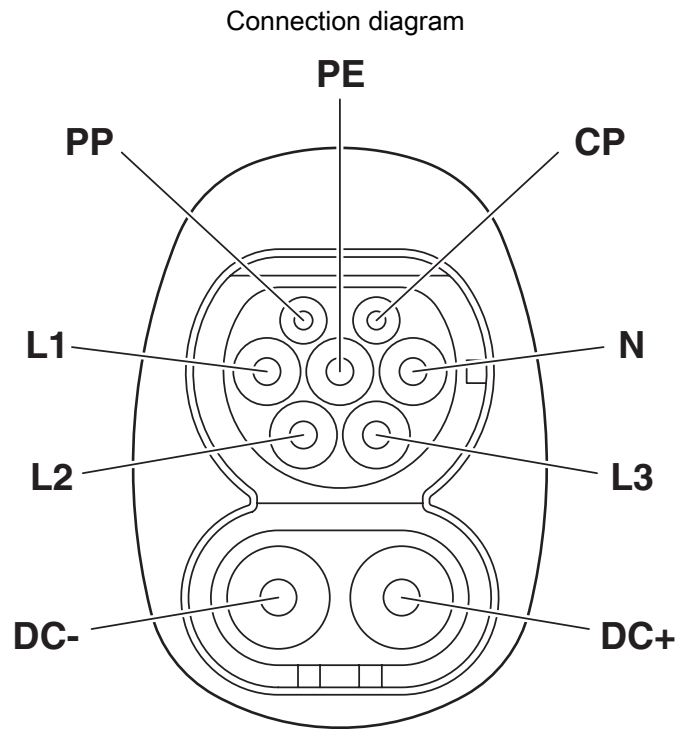

Pin assignment of vehicle charging inlets

# EV-T2MBIE12-3ACDC-INFRA - Vehicle Connector test adapter

1623492

<https://www.phoenixcontact.com/us/products/1623492>

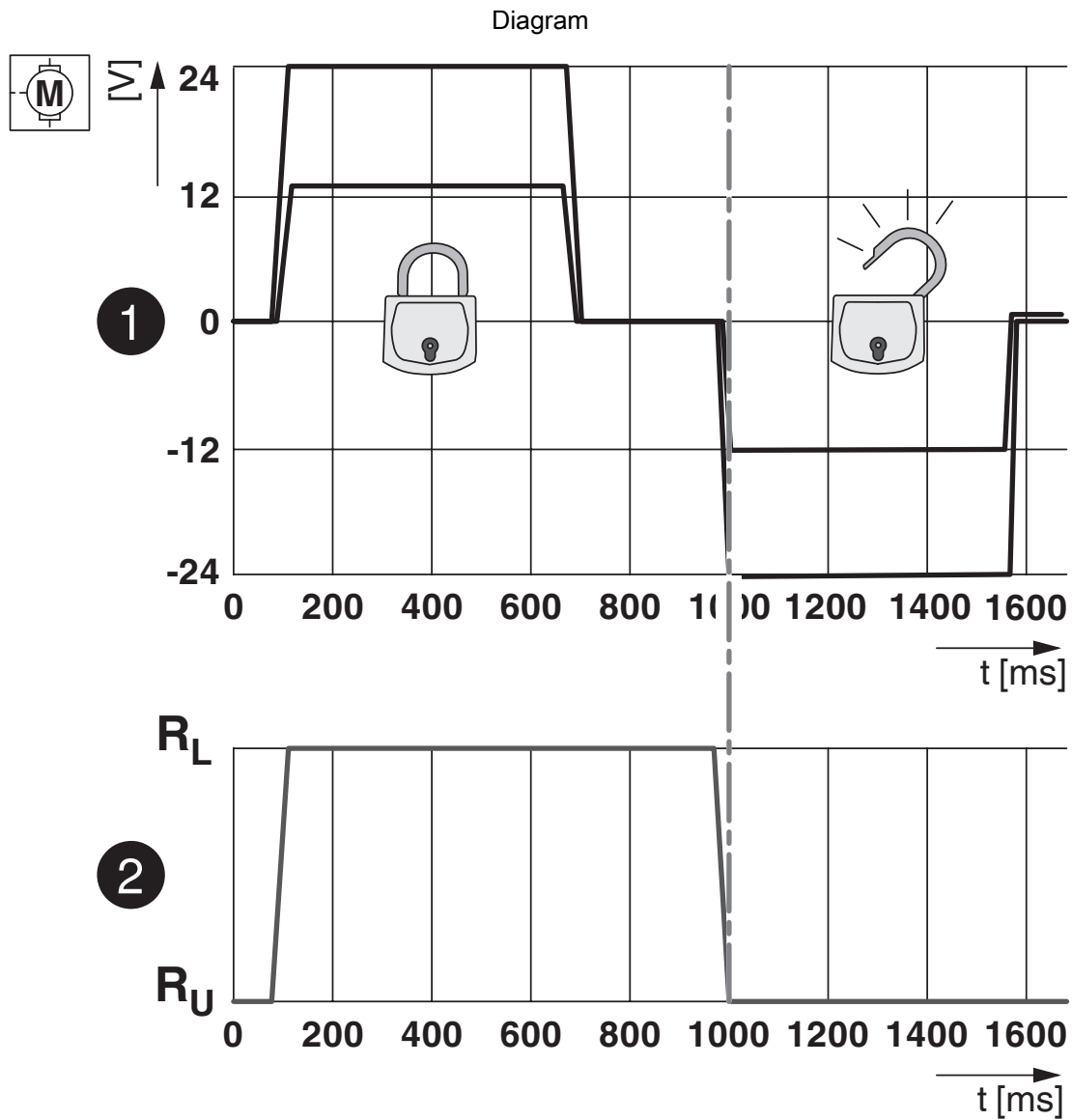

Locking states of the locking actuator

# EV-T2MBIE12-3ACDC-INFRA - Vehicle Connector test adapter

1623492

<https://www.phoenixcontact.com/us/products/1623492>

## Schematic diagram

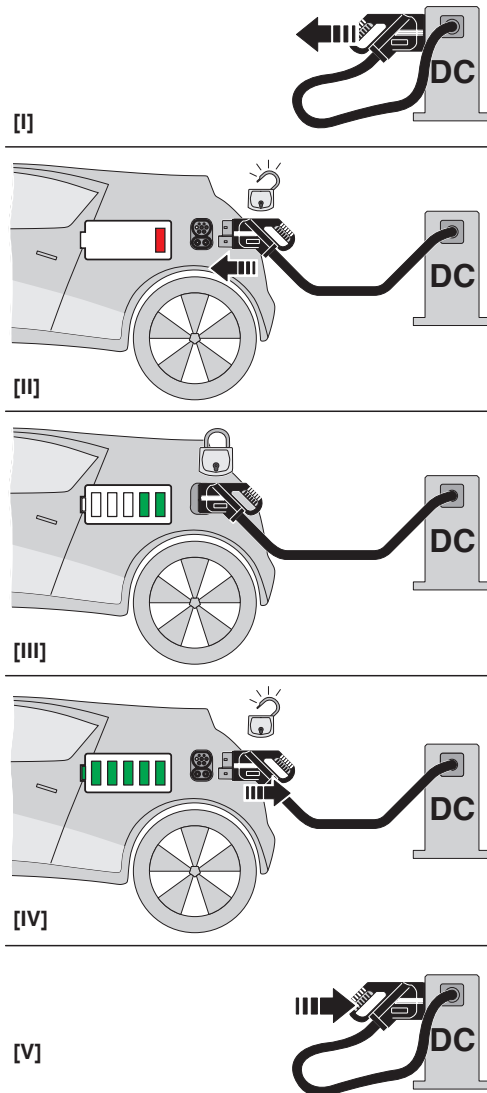

Operating instructions

# EV-T2MBIE12-3ACDC-INFRA - Vehicle Connector test adapter

1623492

<https://www.phoenixcontact.com/us/products/1623492>

Schematic diagram

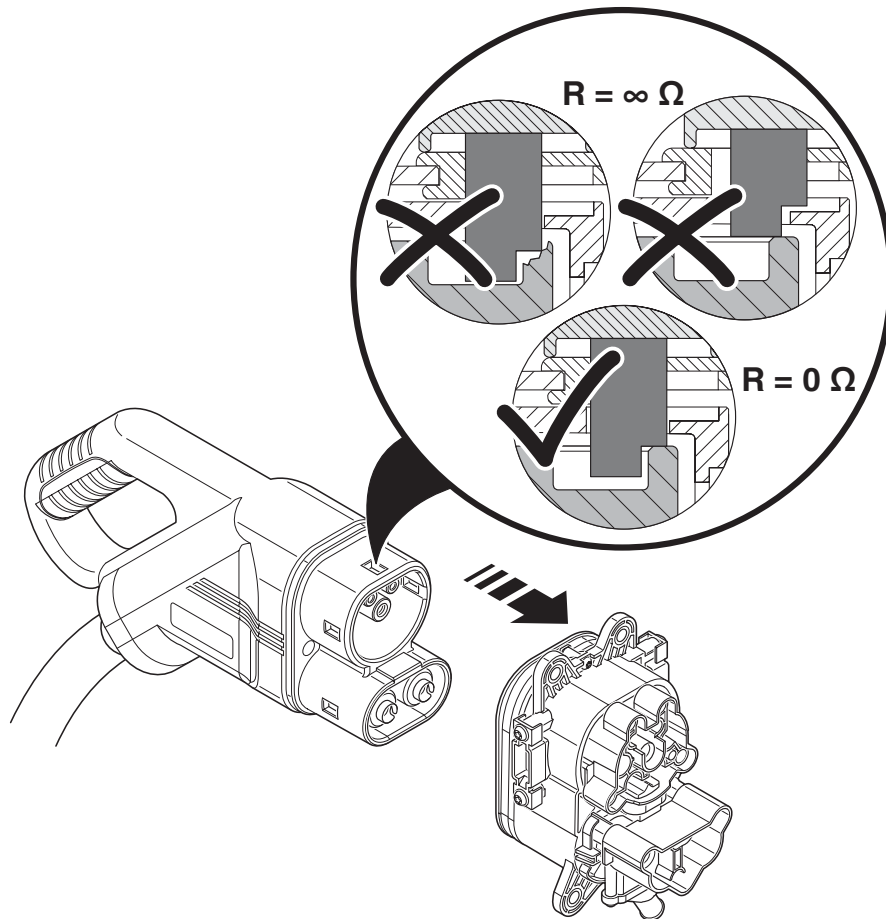

Detection for Vehicle Connector



# EV-T2MBIE12-3ACDC-INFRA - Vehicle Connector test adapter

1623492

<https://www.phoenixcontact.com/us/products/1623492>

Dimensional drawing

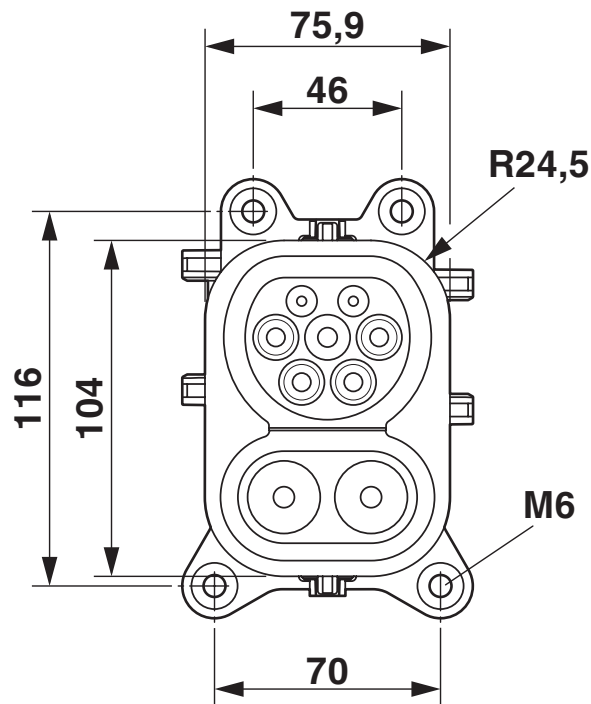

Dimensional drawing top view

Schematic diagram

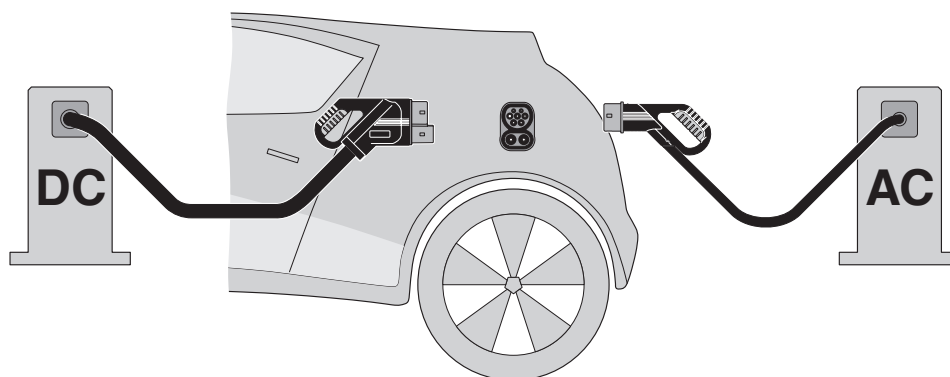

The Combined Charging System (CCS) principle - standard-compliant charging system for electric vehicles, which supports both conventional AC charging and fast DC charging. Both Vehicle Connectors fit into the CCS Vehicle Inlet.

# EV-T2MBIE12-3ACDC-INFRA - Vehicle Connector test adapter



1623492

<https://www.phoenixcontact.com/us/products/1623492>

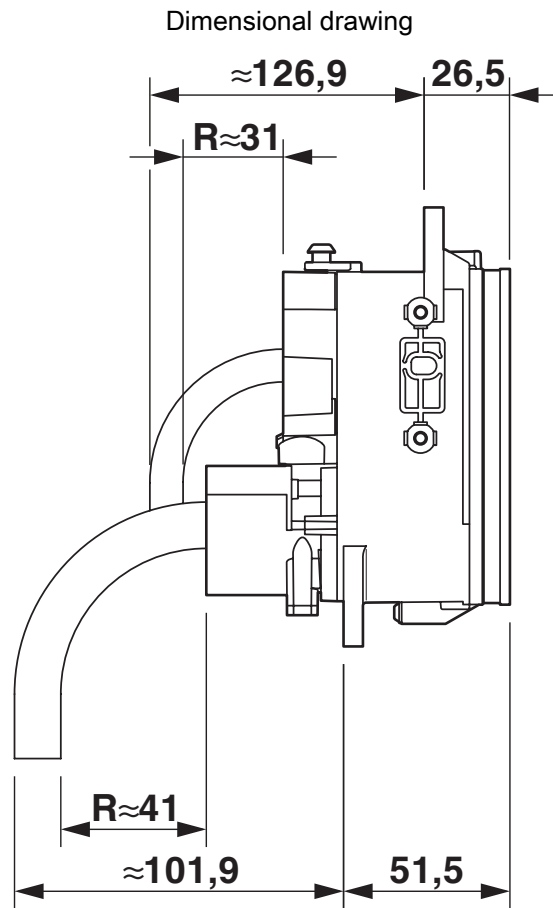

Dimensional drawing, side view

# EV-T2MBIE12-3ACDC-INFRA - Vehicle Connector test adapter



1623492

<https://www.phoenixcontact.com/us/products/1623492>

## Environmental product compliance

### EU REACH SVHC

REACH candidate substance (CAS No.)	
-------------------------------------	--

	No substance above 0.1 wt%
--	----------------------------

# EV-T2MBIE12-3ACDC-INFRA - Vehicle Connector test adapter



1623492

<https://www.phoenixcontact.com/us/products/1623492>

## Accessories

### EV-T2M4CC-DC125A-5,0M50ESBK00 - DC charging cable

1409060

<https://www.phoenixcontact.com/us/products/1409060>



CHARX connect, DC charging cable, with vehicle charging connector and open cable end, for charging electric vehicles (EV) with direct current (DC), CCS type 2, IEC 62196-3, housing: black, gray, PHOENIX CONTACT logo, cable: 5 m, black, straight

---

### EV-T2M3C-3AC20A-5,0M2,5ESBK00 - AC charging cable

1622040

<https://www.phoenixcontact.com/us/products/1622040>



CHARX connect, AC charging cable with Vehicle Connector, open cable end, with protective cap, Type 2, IEC 62196-2, cable: 5 m

# EV-T2MBIE12-3ACDC-INFRA - Vehicle Connector test adapter



1623492

<https://www.phoenixcontact.com/us/products/1623492>

## EV-T2G3C-3AC20A-5,0M2,5ESBK01 - AC charging cable

1627365

<https://www.phoenixcontact.com/us/products/1627365>



CHARX connect comfort, AC charging cable, with vehicle charging connector and open cable end, for charging electric vehicles (EV) with alternating current (AC) via type 2 vehicle charging inlets, with protective cap, Type 2, IEC 62196-2, 20 A / 480 V (AC), housing: black, gray, PHOENIX CONTACT logo, cable: 5 m, black, straight

## EV-T2M3S-E-LOCK12V - Locking

1624129

<https://www.phoenixcontact.com/us/products/1624129>



CHARX connect modular, Locking, Accessories, for attaching to infrastructure charging sockets, Type 2, GB/T, IEC 61851-1, Single wires, length: 0.5 m, locking actuator: 12 V, 4-pos.

# EV-T2MBIE12-3ACDC-INFRA - Vehicle Connector test adapter



1623492

<https://www.phoenixcontact.com/us/products/1623492>

## EV-T2M3S-E-LOCK24V - Locking

1622317

<https://www.phoenixcontact.com/us/products/1622317>

CHARX connect modular, Locking, Accessories, with single-core wires, without holder, for locking infrastructure charging sockets when plug is inserted, Type 2, GB/T, IEC 61851-1, Single wires, length: 0.5 m, locking actuator: 24 V, 4-pos.



---

Phoenix Contact 2024 © - all rights reserved  
<https://www.phoenixcontact.com>

Phoenix Contact USA  
586 Fulling Mill Road  
Middletown, PA 17057, United States  
(+717) 944-1300  
[info@phoenixcon.com](mailto:info@phoenixcon.com)