

NOTE:

- 1.) ALL DIMENSIONS APPLY BEFORE PLATING
- 2.) THDS SHALL BE TO GAUGE FIT AFTER PLATING OR OTHER FINISH
- 3.) SURFACE SHALL BE SMOOTH, AND FREE OF TOOL MARKS
- 4.) BREAK ALL SHARP CORNERS AND REMOVE BURRS
- 5.) CONCENTRICITY TO CENTER AXIS TO BE .002

REVISIONS			
SYM	DESCRIPTION	REVISED BY	DATE

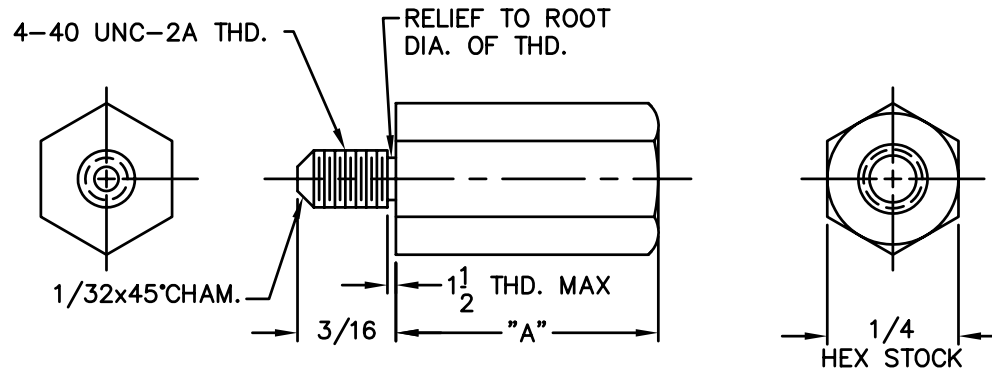
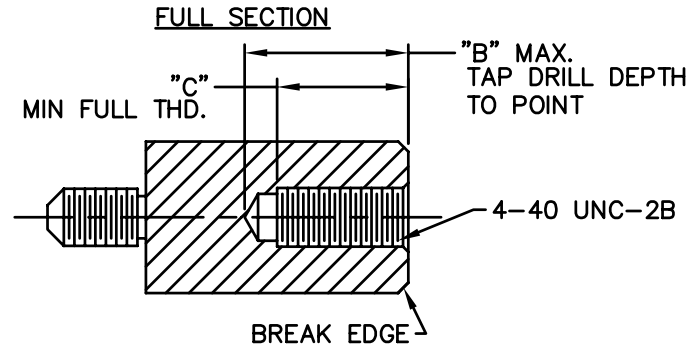

STANDOFF				
PART NO.	LENGTH "A" ±.005	DRILL DEPTH "B" MAX	TAP DEPTH "C" MIN.	
			DIM	NO. THDS
8216	.250	.218	.133	5-6
8217	.375	.312	.250	8-9
8218	.500	.330	.250	10-11
8219	.625	.330	.250	10-11
8220	.750	.330	.250	10-11
8221	.875	.330	.250	10-11
8222	1.000	.330	.250	10-11
8223	1.125	.330	.250	10-11
8224	1.250	.330	.250	10-11
8225	1.375	.330	.250	10-11
8226	1.500	.330	.250	10-11
8227	1.625	.330	.250	10-11
8228	1.750	.330	.250	10-11
8229	2.000	.330	.250	10-11
8230	2.500	.330	.250	10-11
8231	3.000	.330	.250	10-11

MATERIAL: BRASS-ALLOY 360- 1/2 HARD		FINISH: NICKEL		<h1 style="margin: 0;">ABBATRON</h1> <p style="margin: 0;">Electronic Connectors and Hardware 632 Arch Street, Meadville, Pa. 16335</p>			
DIMENSIONAL TOLERANCES UNLESS OTHERWISE SPECIFIED						TITLE: 8216-8231 BRASS HEX MALE/FEMALE STANDOFF	
XX ±.010		XXX ±.005					
FRACTIONS ±1/64		ANGLES ±1°				SCALE 4X	
HEAT TREAT: ---		DRAWN: T. LORD		DATE: 01/7/03			
PLOT SCALE: 1=1		CHECKED: T. LORD		DATE: 01/7/03			
		APPROVED: T.LORD		DATE: 01/7/03			
		B		DRAWING NUMBER			
		SD: 8216-8231		ISSUE			
				Q			