

THIS DOCUMENT IS THE PROPERTY OF
KEYSTONE ELECTRONICS CORP. AND
SHALL NOT BE REPRODUCED, DISTRIBUTED
OR USED AS A BASIS FOR MANUFACTURE
WITHOUT PRIOR WRITTEN PERMISSION
FROM KEYSTONE ELECTRONICS CORP.

ACTUAL SIZE

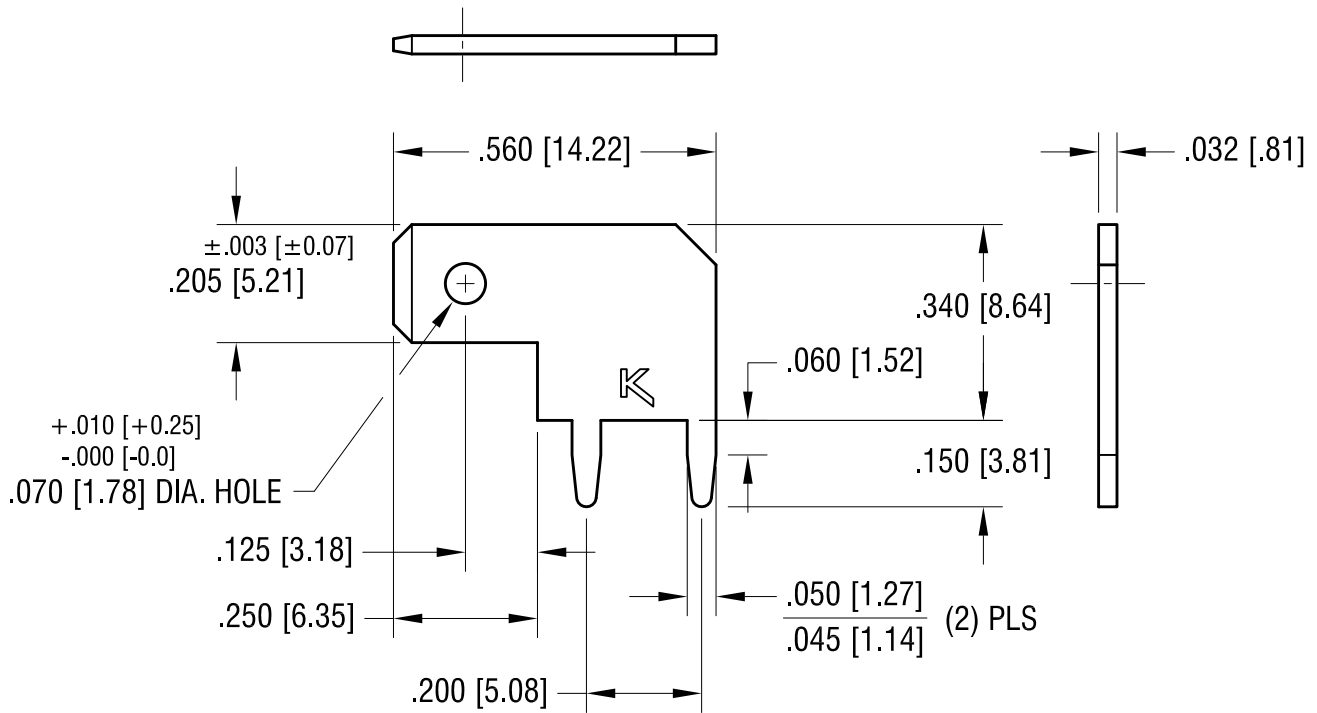
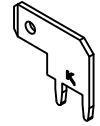

NOTE:

1. MOUNTING HOLE SIZE: .052 [1.32] DIA.
2. FILE NUMBER: E201546

KEYSTONE ELECTRONICS CORP.

www.keyelco.com • NEW HYDE PARK NY 11040 • Tel (516)328-7500

PART NAME

.205 [5.21] PC QUICK-FIT TERMINAL

MATERIAL

.032 [0.81] TH'K BRASS

FINISH

MATTE TIN PLATE

DRN BY

BOONE

DATE

6.14.05

APP'D

MR

SCALE

3X

TOLERANCES

INCH [MM]
DECIMAL ± .005 [± 0.13]

CODE

ANGULAR ± 1°

UNLESS OTHERWISE SPECIFIED

C

DWG NO.

4909

| | | |
|---------|--------------------------|------|
| 9.15.15 | CHANGE AS PER ECN 15-093 | B |
| 6.10.09 | CHANGE AS PER ECN 09-063 | A |
| DATE | DESCRIPTION | REV. |