

PCB LAYOUT
S=2:1

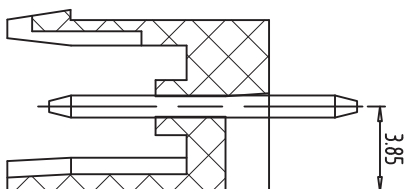

SECTION:A-A

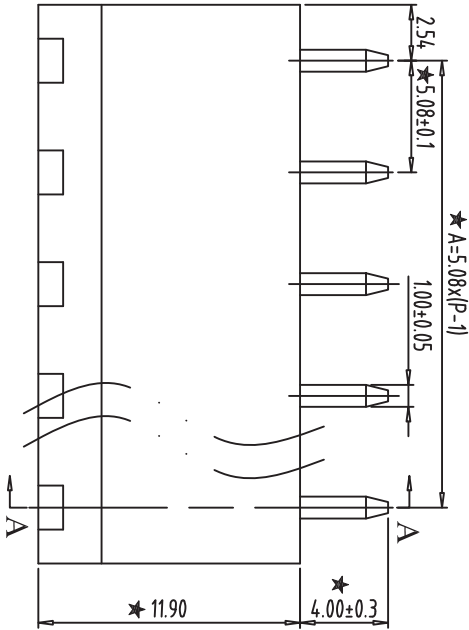
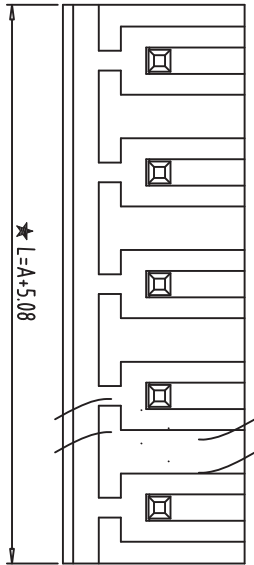
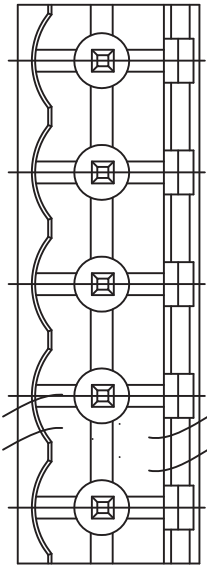
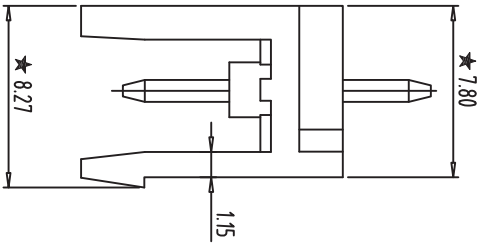

- NOTES:
1. Rating:300V 15A ;
 2. Insulation Withstands Voltage: AC2000V/MIN
 3. Insulation Resistance: 500MΩ or more at DC500V
 4. Using Temperature Range: -40°C~+105°C
 5. "★" is the important dimension
 6. RoHS compliance

Total Pitch Tolerances		Nominal dimension range																						
In mm		In mm																						
0	to	0	30	53	70	90	115	150	250	350	0	30	53	70	90	115	150	200	250	0	10	all	100	150
±0.18	to	±0.25	±0.3	±0.35	±0.44	±0.60	±0.70	±0.85	±0.20	±0.25	±0.30	±0.35	±0.44	±0.55	±0.70	±0.80	±0.90	0.2	0.3	0.3	0.2	0.3	0.3	0.5

ITEM	NAME OF PART	NO. OF PART	Q'TY	MATERIAL	NOTE
DWG	SK	DATE	2014/08/19	SIZE	A4
CHK		DATE		SCALE	3:1
APP.		DATE		SCALE	2EDG-5.08
深圳市金航标电子有限公司			WWW.BDS666.COM		
KH-F400V-3P-5.08G			0755-83044319		