

山一電機株式会社

Better Connection

High Quality and Best Performance

Products & Services

[Test & Burn-in Sockets](#)

[Production IC Sockets](#)

SIP

[IC26 Series](#)

[IC30 Series](#)

[IC140 Series](#)

DIP

[IC26 Series](#)

[IC30 Series](#)

[IC140 Series](#)

SDIP

[IC38 Series](#)

[IC83 Series](#)

[IC310 Series](#)

PLCC

IC160 Series

QFP

[IC149 Series](#)

SOP

[IC179 Series](#)

SSOP

[IC306 Series](#)

[IC307 Series](#)

[Connectors](#)

[Flexible Printed Boards](#)

[Optical Components](#)

[Board Assembly](#)

[Important!](#)

[Catalog](#)

[Contact Us about Products & Services](#)

[News on Our Products & Services](#)

[Exposition Schedule](#)

[Press Releases](#)

IC160 Series



PLCC

1.27mm pitch

[Catalog](#)

Features

Low-profile design mountable on PCB at height 5.0mm (SMT) or 6.0mm (Straight solder dip)

Solder terminal available in three types: SMT lead-foot-patterned (terminal ends invisible); Solder-terminal-out SMT (terminal ends visible); Straight solder dip

Applicable for pick-and-place machine

RoHS compliant

Specifications

Performance

Insulation Resistance 500MΩ min. @ 500VDC

Withstanding Voltage 250VAC rms / minute

Contact Resistance 30mΩ max. @ 10mA

Current Rating 1A

Soldering Conditions VPS, 220°C; IR, 250°C (for SMT type)

Materials

Insulator PA glass-filled, UL94V-0

Contact Copper Alloy, Tin-Bismuth Alloy plating

Ordering Code

IC160 - 032 4- 2 4 0 1
 #1 #2 #3 #4 #5 #6

- #1 IC160 Series
- #2 Number of contacts
- #3 Type of solder terminal
 - 2: SMT & Lead-foot-patterned (invisible)
 - 3: SMT & Solder-terminal-out (visible)
 - 4: Straight solder dip
- #4 Design number
- #5 Positioning pins - 0: Without 1: With
- #6 Packaging
 - No marking: Tray, Buffer Tray
 - 1: Tape & Reel
 - 2: Tube

[To Top](#)

Type of Solder Terminal

SMT & Lead-foot-patterned (invisible)

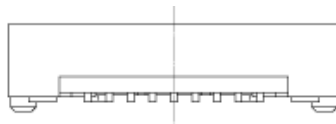

SMT & Solder-terminal-out (visible)



Straight solder dip

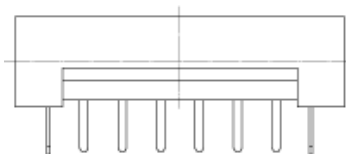

IC Extraction Tool

Part Number: LSI-PULL-19

[News & Events](#)[Products & Services](#)[About Us](#)[Contact Us](#)

Series Lineup

[Applicable IC Dimensions](#)1. SMT w/ lead-foot-patterned tails 

*Please contact our sales site or Distributors for drawing of 32circuits.

Part Number	No. of Contacts	Pitch (mm)	Order Unit		
			Tray	Tape & Reel	Tube
IC160Z-0204-24**	20	1.27	60	500	--
IC160Z-0284-24**	28	1.27	50	500	28
IC160Z-0324-24**	32	1.27	50	500	25
IC160Z-0444-24**	44	1.27	40	400	--
IC160Z-0524-24**	52	1.27	32	400	--
IC160Z-0684-24**	68	1.27	24	250	--
IC160Z-0844-24**	84	1.27	18	150	--

2. SMT w/ outward tails 

*Please contact our sales site or Distributors for drawing of 32circuits.

Part Number	No. of Contacts	Pitch (mm)	Order Unit	
			Tray	Tape & Reel
IC160Z-0204-30**	20	1.27	60	500
IC160Z-0284-30**	28	1.27	50	500
IC160Z-0324-30**	32	1.27	50	500
IC160Z-0444-30**	44	1.27	40	400
IC160Z-0524-30**	52	1.27	32	400
IC160Z-0684-30**	68	1.27	24	250
IC160Z-0844-30**	84	1.27	18	150

3. Straight solder dip 

Part Number	No. of Contacts	Pitch (mm)	Order Unit
			Buffer Tray
IC160Z-0204-40*	20	1.27	126
IC160Z-0284-40*	28	1.27	96
IC160Z-0324-40*	32	1.27	80
IC160Z-0444-40*	44	1.27	54
IC160Z-0524-40*	52	1.27	40
IC160Z-0684-40*	68	1.27	28
IC160Z-0844-40*	84	1.27	24

[To Top](#)