

A SERIES

Battery Connector for Industrial Vehicles

- Up to 400A • Meets or Exceeds EN1175:2020 • cURus Rated • RoHS Compliant
- Acid & Impact Resistant • Industrial Applications



ANDERSON
POWER™

A SERIES BATTERY CONNECTOR

The Anderson™ family of A Series Battery Connectors are expertly designed for ease of use and incorporate an innovative contact carrier to simplify assembly. The A Series connectors include standard 80, 160, and 320 sizes. Robust design and materials offer superior performance. All Materials chosen are RoHS compliant and selected to ensure years of reliability in adverse industrial environments. These attributes make the A Series connectors the ideal choice for a wide range of industrial applications in Material Handling, Battery Charging, Utility Vehicles, Motive Power, and Sweepers/ Scrubbers amongst many others.



KEY ATTRIBUTES

Safety Agency Approvals

EN1175:2020



Voltage Keying

A series connectors offer keys for Dry-Cell, Wet-Cell, and Universal applications coded for 24/36/48/72/80 and 96 volts DC applications.

Sturdy Advanced Polymer Housings

Provide superior resistance to impact, acid and temperature extremes.

Silver Plated Copper Contacts

Provide excellent conductivity and superior mating cycle performance.



SPECIFICATIONS

ELECTRICAL

Current Ratings (Amperes)

Wire Size	A80			A160			A320		
	EN1175	CNR	USR	EN1175	CNR	USR	EN1175	CNR	USR
10 mm ²	N/A	70	90	N/A	N/A	N/A	N/A	N/A	N/A
16 mm ²	80	120	120	80	90	120	N/A	N/A	N/A
25 mm ²	120	140	140	120	120	160	N/A	N/A	N/A
35 mm ²	160	160	160	160	140	180	N/A	N/A	N/A
50 mm ²	N/A	N/A	N/A	250	160	220	250	165	220
1/0 AWG	N/A	N/A	N/A	N/A	N/A	N/A	N/A	190	270
70 mm ²	N/A	N/A	N/A	N/A	N/A	N/A	N/A	200	260
3/0 AWG	N/A	N/A	N/A	N/A	N/A	N/A	N/A	240	300
95 mm ²	N/A	N/A	N/A	N/A	N/A	N/A	400	245	425
4/0 AWG	N/A	N/A	N/A	N/A	N/A	N/A	N/A	250	425
120 mm ²	N/A	N/A	N/A	N/A	N/A	N/A	N/A	260	450

Note:

All auxiliary contacts regardless of wire size are rated to a min 20 amps when tested to EN1175:2020 testing requirements

EN1175:2020 allows for maximum temperature rise=65°C (above 25±5°C ambient)

CNR allows for maximum temperature rise =30°C (above 25°C ambient)

USR allows for total temperature (based on min. 25°C ambient)=105°C

Voltage Rating A80 - A160 - A320

	cUR	UR	EN1175
AC / DC	600V	600V	150V
DWV (AC)	2200	2200	2200

Wire Range	A80		A160		A320	
	mm ²	AWG	mm ²	AWG	mm ²	AWG
Power- Min.	10	8	16	6	50	1/0
Power- Max.	35	2	50	1/0	120	4/0
Upper Aux. - Min.	1.5	18	4	12	4	12
Upper Aux. - Max.	2.5	14	4	12	4	12
Lower Pilot Aux. - Min.	1.5	18	6	10	6	10
Lower Pilot Aux. - Max.	2.5	14	6	10	6	10

Average Initial Contact Resistance Across Mated Connector Micro-ohms

	A80	A160	A320
Avg. Contact Resistance - Power	65	55	30
Avg. Contact Resistance - Aux.	1100	920	1000

Operating Temperature (all Series): -25 to 105°C

MECHANICAL

Life Cycle - Per EN1175:2020

Mating Cycles	A80	A160	A320
No Load	>5000	>5000	>5000
Under Load (Hot Plug at 96V)	5 at 400A	5 at 400A	N/A

Miscellaneous Data	A80	A160	A320
Avg. Mating Force N (lb)	68 (15.3)	170 (38.2)	71 (16.0)
Contact Retention N (lb)	134 (30) min	445 (100) min	445 (100) min
Degree of Protection	IP23	IP23	IP23
Acid Resistance	Per EN1175:2020		
Flammability	UL94 HB, Horizontal Burn		

MATERIALS

	A80 - A160 - A320
Housings	PA6 (Nylon) glass filled
Contacts	Copper alloy silver plate
Contact Plating Power (min.)	Silver Plating - 6 microns
Contact Plating Auxiliary (min.)	Silver Plating - 6 microns
Hardware	Steel, zinc chromate plate

TEMPERATURE CHARTS

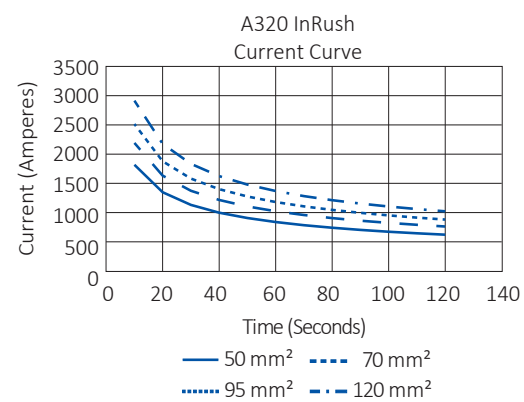
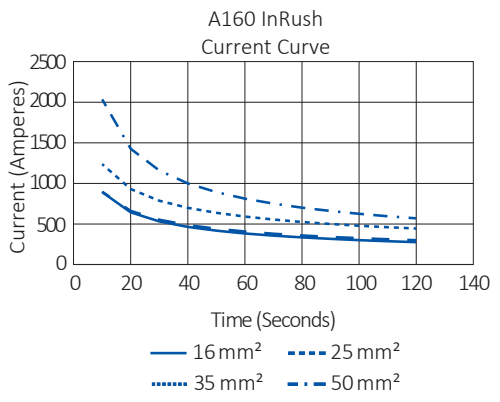
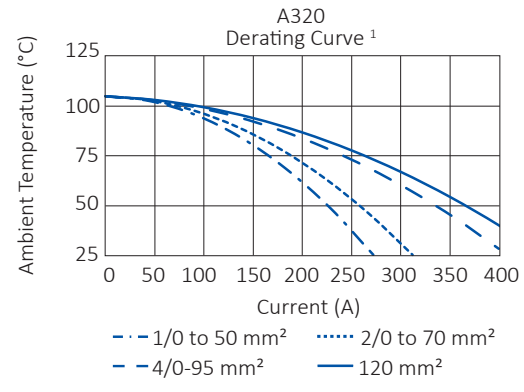
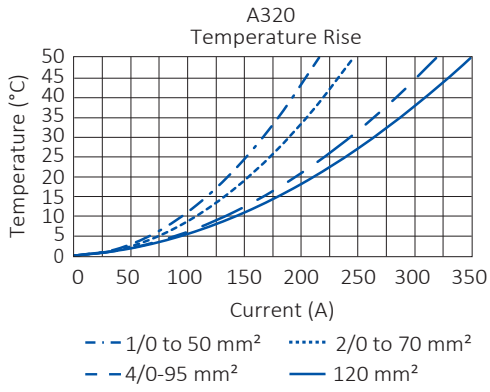
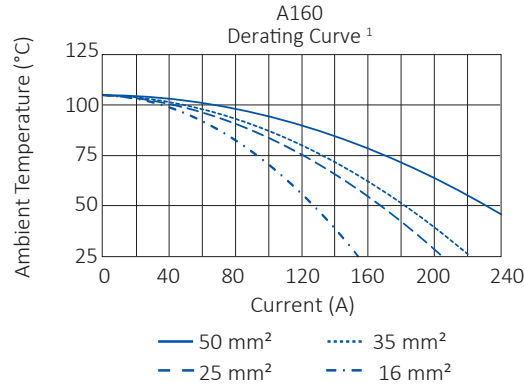
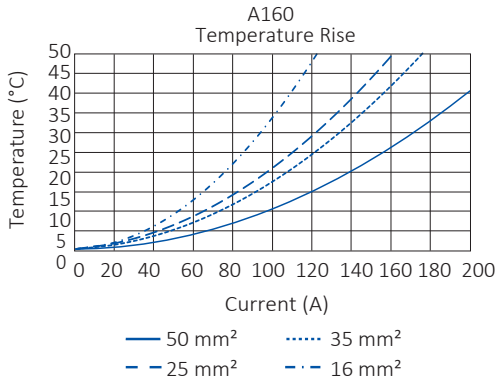
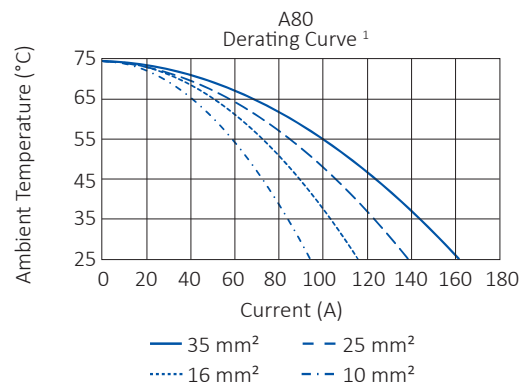
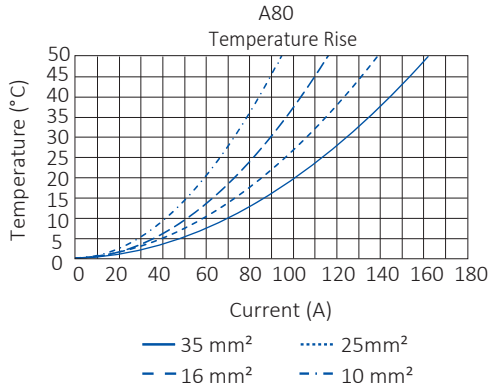

¹ 0.8 Derating per IEC 60512-3
 NOTE 1: Temperature ratings based on power contacts energized only.
 NOTE 2: Temperature rise charts are based on a 25°C ambient temperature.

ORDERING INFORMATION

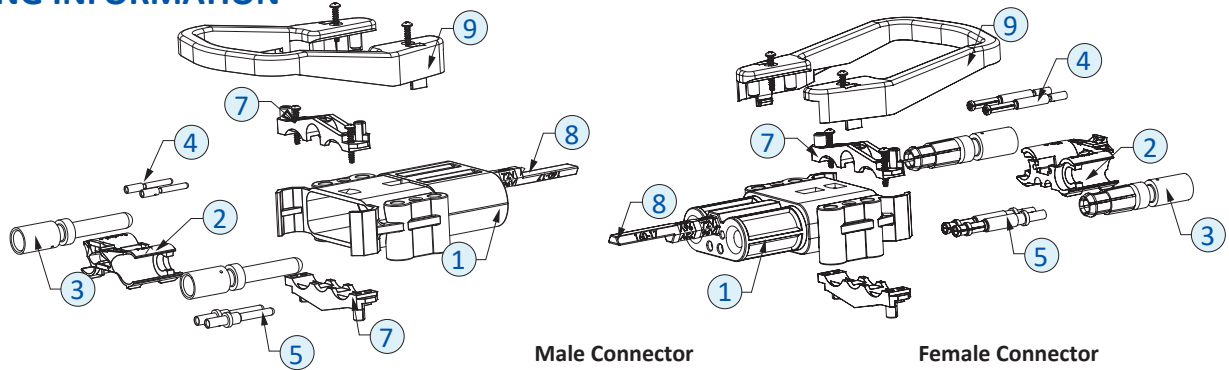

Components							
Item Number	Description - mm ² (AWG)	A80		A160		A320	
		Male	Female	Male	Female	Male	Female
3	Power Contacts						
	Power Contact 10 mm ² (8 AWG)	80-1010	80-1110	N/A	N/A	N/A	N/A
	Power Contact 16 mm ² (6 AWG)	80-1016	80-1116	160-1016	160-1116	N/A	N/A
	Power Contact 25 mm ² (4 AWG)	80-1025	80-1125	160-1025	160-1125	N/A	N/A
	Power Contact 35 mm ² (2 AWG)	80-1035	80-1135	160-1035	160-1135	N/A	N/A
	Power Contact 50 mm ² (1 AWG to 1/0)	N/A	N/A	160-1050	160-1150	320-1050	320-1150
	Power Contact 70 mm ² (2/0 to 3/0)	N/A	N/A	N/A	N/A	320-1070	320-1170
	Power Contact 95 mm ² (3/0 to 4/0)	N/A	N/A	N/A	N/A	320-1095	320-1195
	Power Contact 120 mm ² (4/0)	N/A	N/A	N/A	N/A	320-1004	320-1104
4	Upper Auxiliary Contact 4 mm ² (12 AWG)	N/A	N/A	160-14	160-15	160-14	160-15
	Upper Auxiliary Contact 1.5 mm ² /2.5 mm ² (18/14 AWG)	E80-32	E80-33	320-24	320-25	320-24	320-25
5	Lower Pilot Auxiliary Contact 6 mm ² (10 AWG)	NA	NA	160-12	160-13	160-12	160-13
	Lower Pilot Auxiliary Contact 1.5mm / 2.5 mm- (18/14 AWG)	E80-30	E80-31	320-22	320-23	320-22	320-23
8	Voltage Coding Pins						
	Grey Coding Pin - Wet (160 and 320 use same Coding Pins)	80-9	80-9	160-9	160-9	160-9	160-9
	Green Coding Pin - Dry (160 and 320 use same Coding Pins)	80-17	80-17	160-17	160-17	160-17	160-17
	* Yellow Coding Pin - Universal (160 and 320 use same Coding Pins)	80-19	Not Used	160-19	Not Used	160-19	Not Used
	Blue Coding Pin-Type II dry (160 and 320 use same Coding Pins)	80-22M	80-22F	160-22M	160-22F	160-22M	160-22F
	Red Coding Pin-Type II wet (160 and 320 use same Coding Pins)	80-23M	80-23F	160-23M	160-23F	160-23M	160-23F
9	** Handle - High Profile with Screws	N/A	N/A	320-8	320-8	320-8	320-8
	** Handle - Low Profile with Screws	80-89	80-89	160-8	160-8	160-8	160-8
	Handle Red - Low Profile with Screws	80-8-R	80-8-R	N/A	N/A	N/A	N/A
1	Housing Only	80-1	80-2	160-1	160-2	320-1	320-2
2	Contact Holder	80-5B	80-5B	160-5	160-5	320-5	320-5
7	Cable Clamps with Screws	80-67	80-67	160-67	160-67	320-67	320-67
1+2+7+8	Male Housing with Contact Holder and Cable Clamp with Screws (Gray Key) - Individual Pack	A80400-0009		A16400-0009		A32400-0009	
1+2+7+8	Female Housing with Contact Holder, Cable Clamps with Screws - (Gray Key) - Individual Pack		A80500-0009		A16500-0009		A32500-0009
1+2+7+ 8	Male Housing with Contact Holder and Cable Clamp with Screws (Green Key) - Individual Pack	A80400-0209		A16400-0209		A32400-0209	
1+2+7+8	Female Housing with Contact Holder, Cable Clamps with Screws - (Green Key) - Individual Pack		A80500-0209		A16500-0209		A32500-0209
1+2+7+ 8	Male Housing with Contact Holder and Cable Clamp with Screws (Yellow Key) - Individual Pack	A80400-0309		A16403-0309		A32400-0309	

* Universal yellow coding key is only used on male connectors

** A160 and A320 handles work with both the A160 and A320 series connectors

PART NUMBER CONFIGURATOR

A80 Connector Part Number Selection

Series	Gender	Main Contact	Handle	Coding Key	Auxiliary Contacts	Packing
A80	4 or 5	25 -	1	0	0	9
4	Male					9 Individual
5	Female					8 Bulk
00	None - Order Separately				0 None	
10	10 mm ² (8 AWG)				A (2) Lower Pilot Auxiliary Contacts	
16	16 mm ² (6 AWG)				B (2) Upper Auxiliary Contacts	
25	25 mm ² (4 AWG)				C (2) Lower Pilot Auxiliary Contacts & (2) Upper Auxiliary Contacts	
35	35 mm ² (2 AWG)					
0	No		0	Grey, Wet Cell		
1	Black		2	Green, Dry Cell		
2	Red		3	Yellow, Universal (use with male housing only)		
			4	Blue, Type II Dry Cell, High Power Coding Pin		
			5	Red, Type II Wet Cell, High Power Coding Pin		

A160 Connector Part Number Selection

Series	Gender	Main Contact	Handle	Coding Key	Auxiliary Contacts	Packing
A16	4 or 5	25 -	1	0	0	9
4	Male					9 Individual
5	Female					8 Bulk
00	None - Order Separately				0 None	
16	16 mm ² (6 AWG)					mm² AWG
25	25 mm ² (4 AWG)				A (2) Lower Auxiliary Contacts	6 10
35	35 mm ² (2 AWG)				B (2) Upper Auxiliary Contacts	4 12
50	50 mm ² (1/0 AWG to 1 AWG)				C (2) Lower Auxiliary Contacts & (2) Upper Auxiliary Contacts	6 10
0	No					4 12
1	Black				D (2) Lower Auxiliary Contacts	1.5/2.5 18/14
					E (2) Upper Auxiliary Contacts	1.5/2.5 18/14
			0	Grey, Wet Cell	F (2) Lower Auxiliary Contacts & (2) Upper Auxiliary Contacts	1.5/2.5 18/14
			2	Green, Dry Cell		1.5/2.5 18/14
			3	Yellow, Universal (use with male housing only)		
			4	Blue, Type II Dry Cell, High Power Coding Pin		
			5	Red, Type II Wet Cell, High Power Coding Pin		

A320 Connector Part Number Selection

Series	Gender	Main Contact	Handle	Coding Key	Auxiliary Contacts	Packing
A32	4 or 5	50 -	1	0	0	9
4	Male					9 Individual
5	Female					8 Bulk
00	None - Order Separately				0 None	
50	50 mm ² (1/0 AWG to 1 AWG)					mm² AWG
70	70 mm ² (2/0 AWG to 3/0 AWG)				A (2) Lower Auxiliary Contacts	1.5/2.5 18/14
95	95 mm ² (3/0 AWG to 4/0 AWG)				B (2) Upper Auxiliary Contacts	1.5/2.5 18/14
12	120 mm ² (4/0 AWG)				C (2) Lower Auxiliary Contacts & (2) Upper Auxiliary Contacts	1.5/2.5 18/14
0	No					1.5/2.5 18/14
1	Black				D (2) Lower Auxiliary Contacts	6 10
					E (2) Upper Auxiliary Contacts	4 12
			0	Grey, Wet Cell	F (2) Lower Auxiliary Contacts & (2) Upper Auxiliary Contacts	6 10
			2	Green, Dry Cell		4 12
			3	Yellow, Universal (use with male housing only)		
			4	Blue, Type II Dry Cell, High Power Coding Pin		
			5	Red, Type II Wet Cell, High Power Coding Pin		

Packaging: Individual (Kits) - all components for a complete connector are packaged together in individual bags within one box. Bulk (Kits) - all components required are packaged separately by part number selected in one bag/box.

Handles: A80 comes with the low profile T handle • A160 comes with the low profile handle • A320 comes with the high profile handle.

DRAWINGS

Housing Dimensions

		A80		A160		A320	
		mm	in	mm	in	mm	in
Male Housings	A	68.0	2.68	83.5	3.29	89.5	3.52
	B	74.4	2.93	103.8	4.09	123.5	4.86
	C	26.1	1.03	33.4	1.31	40.8	1.61
Female Housings	A	68.0	2.68	83.5	3.29	89.5	3.52
	B	73.8	2.91	104.0	4.09	117.0	4.61
	C	26.1	1.03	32.6	1.28	37.6	1.48

Male Front View

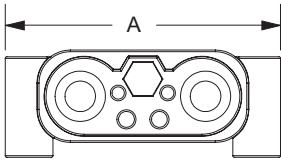

Male Top View

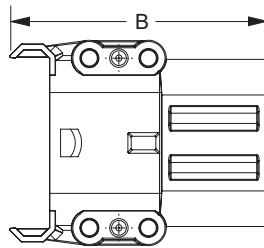

Male Side View

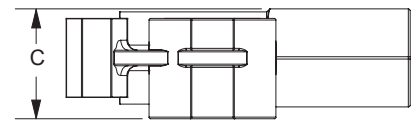

Female Front View

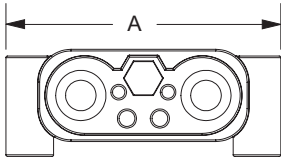

Female Top View

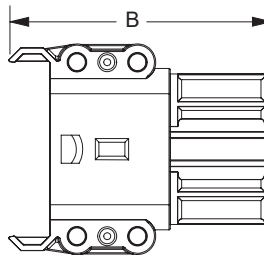

Female Side View

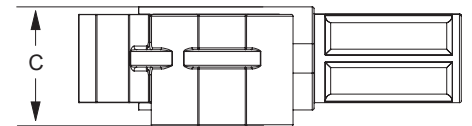

Dimensions of Housings With Handles

		A80	
		mm	in
Male Housings	D	68.0	2.68
	E	41.2	1.62
	F	110.6	4.35
Female Housings	D	70.0	2.76
	E	41.20	1.62
	F	110.6	4.35

A80 Male Housing with Handle

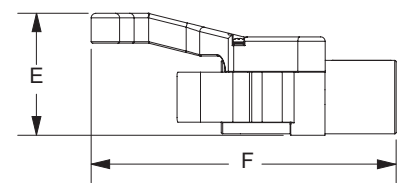
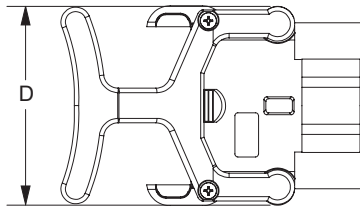

A80 Female Housing with Handle

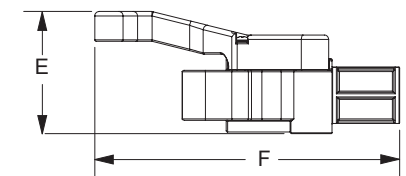
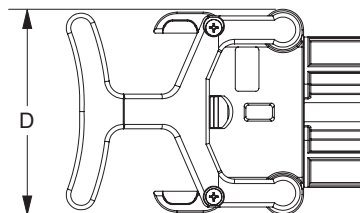

A160 Handles

		Low Profile		High Profile				Low Profile		High Profile	
		mm	in	mm	in			mm	in	mm	in
		Male Housings	D	101	4.0			106	4.2	Female Housing	D
E	46		1.8	64	2.5	E	46	1.8	64		2.5
F	168		6.6	167	6.6	F	173	6.8	172		6.8

Male Housing Low Profile Handle

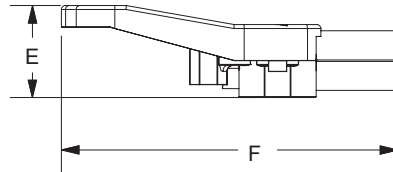
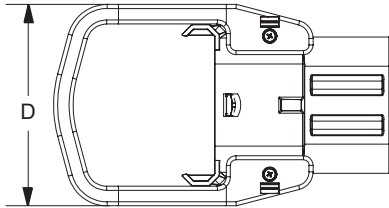

Male Housing High Profile Handle

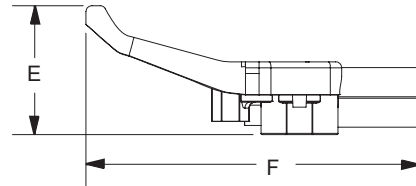
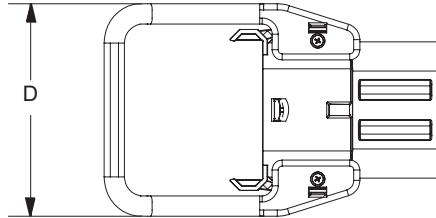

Female Housing Low Profile Handle

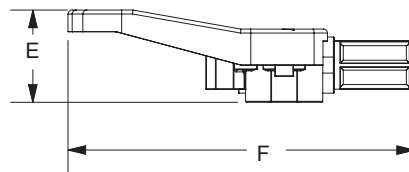
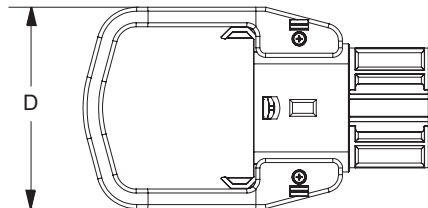

Female Housing High Profile Handle

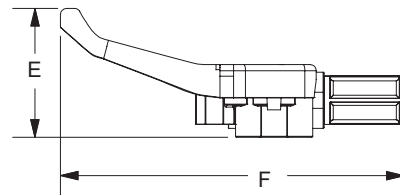
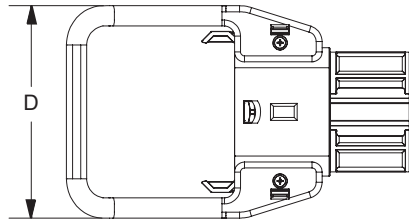

A320 Handles

		Low Profile		High Profile				Low Profile		High Profile	
		mm	in	mm	in			mm	in	mm	in
		Male Housings	D	101	4.0			106	4.2	Female Housing	D
E	54		2.1	72	2.8	E	53	2.1	71		2.8
F	175		6.9	174	6.9	F	171	6.7	173		6.8

Male Housing Low Profile Handle

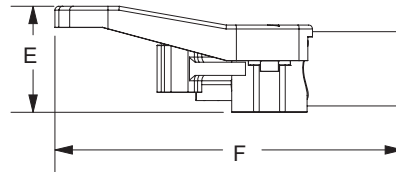
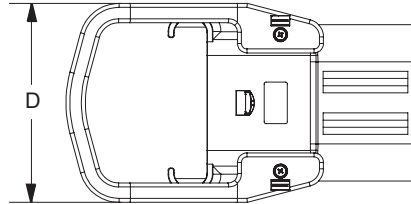

Male Housing High Profile Handle

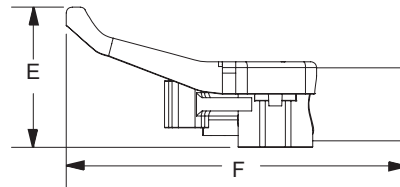
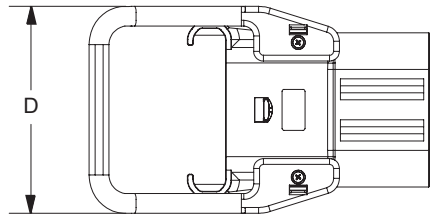

Female Housing Low Profile Handle

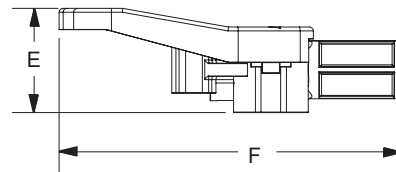
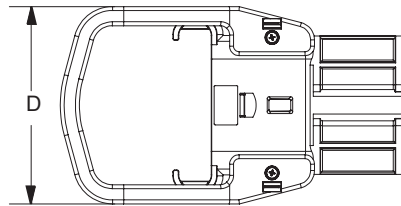

Female Housing High Profile Handle

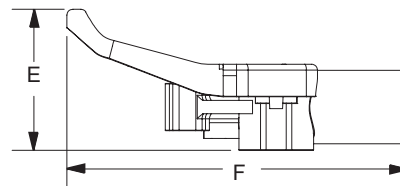
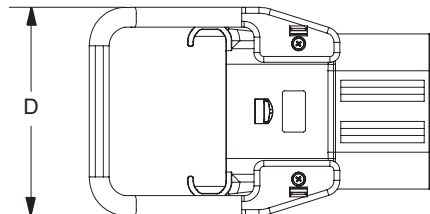

Latch Plate 160 & 320
Part Number A320LP-MK

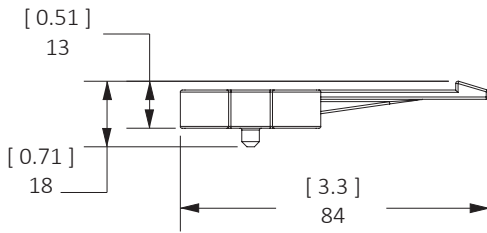
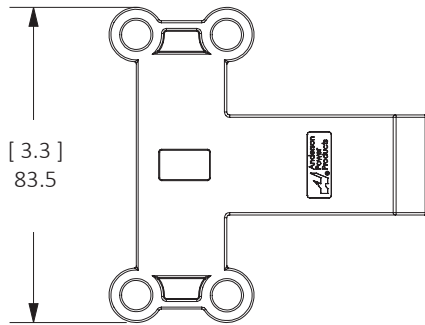

Latch Plate on
A160 & 320 Male Housing

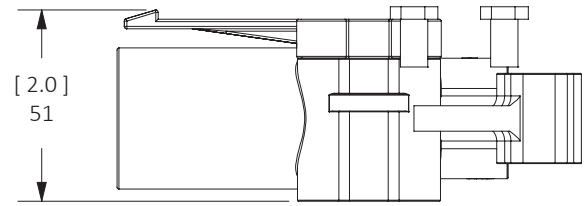

* Latch provides 150 lbf. retention before opening without damage

Handle & Lever Assembly on A160 & 320 Female Housing
Part Number A320HL-MK

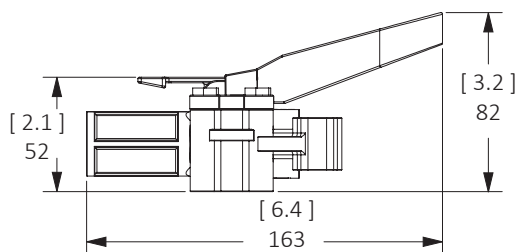
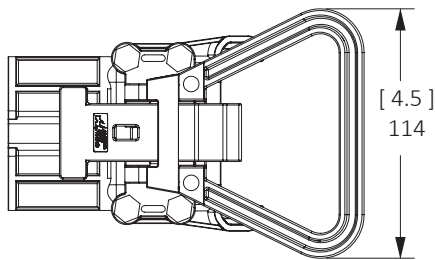

MANUAL RELEASE For A160 & 320

Charger Truck Side Part Number 994G4

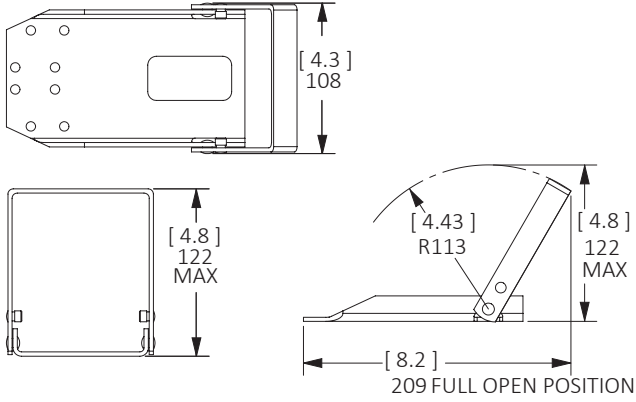

Battery Bracket Part Number 993G4

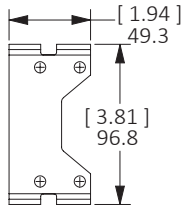

Manual Release with Connectors

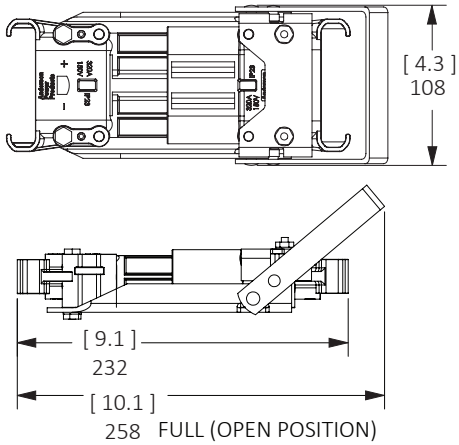

DOUBLE STACK For A160 & 320

Charger Truck Side Part Number 994G6

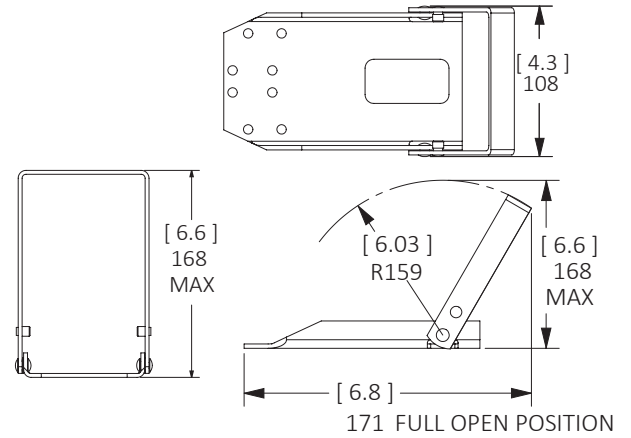

Battery Bracket Part Number 993G6

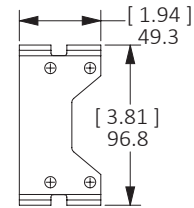

Double Stack with Connectors

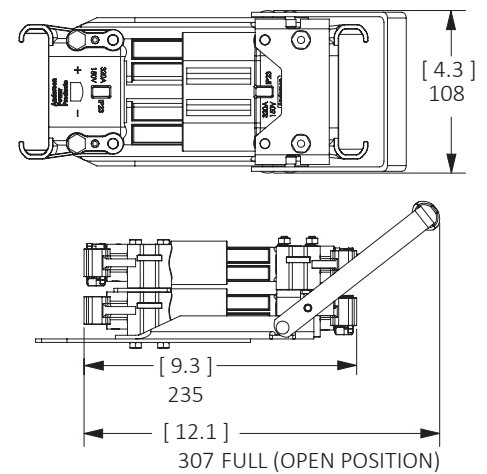

Manual Release and Double Stack Bracket

Part Number	Description
993G4	Manual Release Battery Bracket
993G6	Din 320 (A/E) Double Stack Battery Bracket Series
994G4	Manual Release for A160 & 320
994G6	Din 320 (A/E) Double Stack Truck Charger Bracket Series



Manual Release

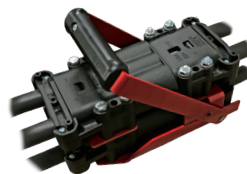

Double Stack

Contacts

Series	Wire Size		OD		ID	
	Metric	AWG	mm	in	mm	in
A80	10 mm ²	6 to 8	6.0	0.24	4.5	0.18
A80 / 160	16 mm ²	4 to 6	8.4	0.33	6.0	0.24
	25 mm ²	2 to 4	11.0	0.43	8.0	0.31
	35 mm ²	1 to 2	12.5	0.49	9.0	0.35
A160 / 320	50 mm ²	1 to 1/0	14.5	0.57	11.0	0.43
A320	70 mm ²	2/0 to 3/0	17.0	0.67	13.0	0.51
	95 mm ²	3/0 to 4/0	19.8	0.78	15.0	0.59
	120 mm ²	4/0	19.8	0.78	15.6	0.61



Male Power Contact

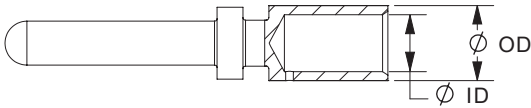

Female Power Contact

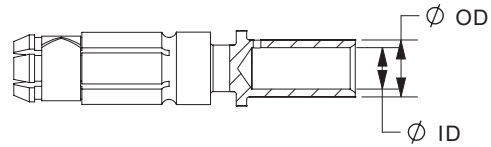

Auxiliary Contacts

Series	Part Number	Position	Wire Size		OD		ID	
			mm ²	AWG	mm	in	mm	in
A80	E80-32 / E80-33	Upper	1.5 / 2.5	18 / 14	3.9	0.15	2.2	0.09
	E80-30 / E80-31	Lower	1.5 / 2.5	18 / 14	3.9	0.15	2.2	0.09
A160	160-14 / 160-15	Upper	4	12	4.1	0.16	2.9	0.11
	320-24 / 320-25	Lower	1.5 / 2.5	18 / 14	4.6	0.18	2.2	0.09
A320	160-12 / 160-13	Upper	6	10	5	0.2	3.9	0.15
	320-22 / 320-23	Lower	1.5 / 2.5	18 / 14	4.6	0.18	2.2	0.09

Upper Auxiliary Pin Typical of A80

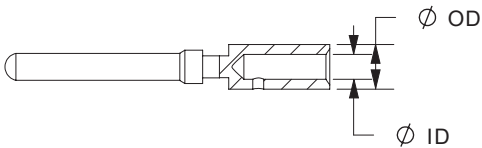

Upper Auxiliary Socket Typical of A80

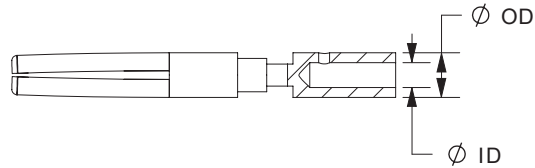

Upper Auxiliary Pin Typical of A160 / 320

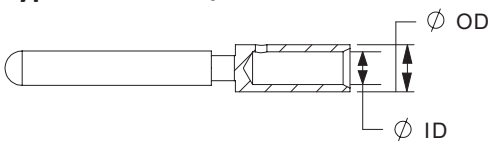

Upper Auxiliary Socket Typical of A160 / 320

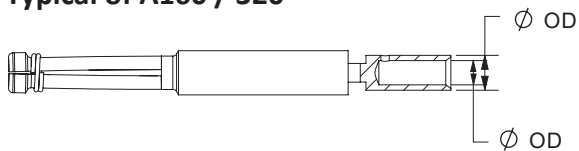

**Lower Pilot Auxiliary Pin
Typical of A80**

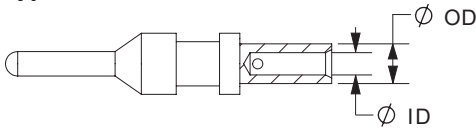

**Lower Auxiliary Socket
Typical of A80**

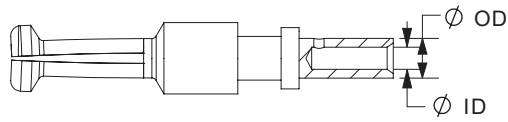

**Lower Pilot Auxiliary Pin
Typical of A160 / 320**

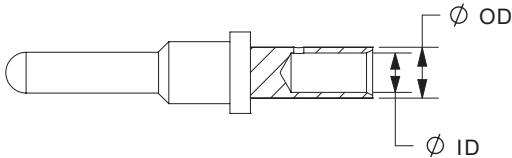

**Lower Auxiliary Socket
Typical of A160 / 320**

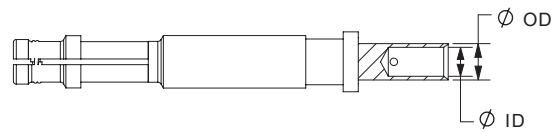

Wet / Dry Voltage Key

Series	K		L		K		L	
	mm	in	mm	in	mm	in	mm	in
A80	8.0	0.31	46	1.77	8.0	0.31	46	1.77
A160 / 320	9.3	0.37	69	2.72	9.3	0.37	69	2.72

Wet / Dry Voltage Key - Grey or Green

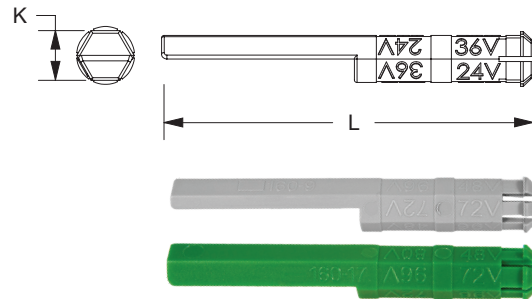

Keying Plug	Identification	Assembled In
	Used for Wet Cell Battery /Charger – Color Grey	Battery Receptacle and Charging Plug
	Used for Dry Cell Battery/Charger – Color Green	Battery Receptacle and Charging Plug
	Used for Vehicle only - Yellow (Universal)	Vehicle Plug only- used when vehicle may use wet or dry cell batteries.
	Used for Type II Dry Cell Battery/Charger - Color Blue	Battery Receptacle and Charging Plug
	Used for Type II Wet Cell Battery/Charger - Color Red*	Battery Receptacle and Charging Plug

**Universal Voltage Key - Yellow
(Use with male housing only)**

Universal (Yellow) voltage keys are to be used exclusively at the vehicle side to permit both the use of wet-cell and dry-cell batteries.

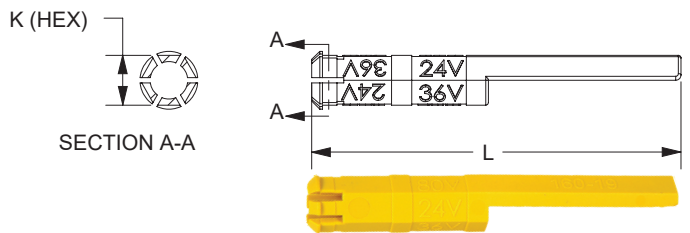

**Type II Dry Cell Battery/Charger Key- Blue
(Male & Female)**



**Type II Wet Cell Battery/Charger Key- Red
(Male & Female)**



TOOLING INFORMATION

A Series A80, A160, & A320 Hydraulic Tooling								
Wire Size		Part Numbers		Loose Piece Contact Crimp Tools				
mm ²	AWG	Power Contact	Hydraulic Hand Bench Tool	+	Die	or	Hydraulic Hand Bench Tool	
10 mm ²	8 to 6	80-1010 80-1110	1387G3 or Cembre B500A ¹		1322G16		N/A	
N/A	6	80-1016 80-1116			1322G9			
16 mm ²	N/A	80-1016 80-1116			1322G10			
25 mm ²	4 to 2	80-1025 80-1125			1322G12			
35 mm ²	2 to 1	80-1035 80-1135			1322G15			
16 mm ²	6 to 4	160-1016 160-1116			1322G9			
25 mm ²	4 to 2	160-1025 160-1125	1322G12					
35 mm ²	2 to 1	160-1035 160-1135	1387G3 or Cembre B500A ¹		1322G7		1368 Series	
50 mm ²	1 to 1/0	160-1050 160-1150 320-1050 320-1150			1322G4 1322G4			
70 mm ²	2/0	320-1070 320-1170			1322G3 (K) * 1322G2			
95 mm ²	3/0 to 4/0	320-1095 320-1195			1322G1			
120 mm ²	4/0	320-1004			N/A			N/A
		320-1104						
Pilot/Auxiliary Contacts								
All		Pins	Solder Only					
		Sockets						

* Use 1322G3 with K stranded wire only.

¹ www.cembreinc.com



1387G3 or Cembre B500A ¹



1368



1368-NL



1368-B

A Series A80, A160, & A320 Pneumatic Tooling

Wire Size		Part Numbers		Loose Piece Contact Crimp Tools			
mm ²	AWG	Power Contact	Pneumatic Bench Tool	+	Die	+	Locator (Single Crimp)
10 mm ²	8 to 6	80-1010	N/A	+	N/A	+	N/A
		80-1110					
16 mm ²	6 to 4	80-1016					
		80-1116					
25 mm ²	4 to 2	80-1025					
		80-1125					
35 mm ²	2 to 1	80-1035					
		80-1135					
mm ²	AWG	Power Contact	Pneumatic Bench Tool	+	Die	+	Locator (Double Crimp)
16 mm ²	6 to 4	160-1016	1387G2	+	1303G14	+	1304G21 Sockets 1304G20 Pins
		160-1116			1303G13		
25 mm ²	4 to 2	160-1025					
		160-1125					
35 mm ²	2 to 1	160-1035					
		160-1135					
50 mm ²	1 to 1/0	160-1050					
		160-1150			1303G8		
		320-1050					
		320-1150					
70 mm ²	2/0 AWG	320-1070					
		320-1170			1303G11		
95 mm ²	3/0 AWG	320-1095					
		320-1195			1303G3		
120 mm ²	4/0 AWG	320-1004					
		320-1104					
Pilot/Auxiliary Contacts							
All		All Crimp Pins	Solder Only				
		All Crimp Sockets					



1387G1 & 1387G2

ADDITIONAL PRODUCTS FOR INDUSTRIAL VEHICLES



SBE®320 & SBX®350 - up to 550 Amps

- Touch Safe
- EN1175: 2020
- Up to 8 Auxiliaries



SB® - up to 450 Amps

- Genderless Housings
- Hot Plugging AC or DC
- Keyed Housings

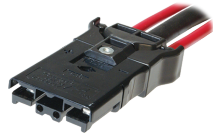

SBS®75X - up to 110 Amps

- Wire-to-Wire / Wire-to-Board
- Touch Safe Interface
- Ground or Auxiliary Positions



All Data Subject to Change Without Notice 2023-0108 DS-DIN-A REV 3 **Your Best Connection™**

Anderson™ will use reasonable efforts to include accurate and up-to-date content in the catalog. All product information contained in the catalog including ordering information, illustrations, specifications, and dimensions, are believed to be reliable as of the date of publishing, but is subject to change without notice. Anderson makes no warranty or representation as to its accuracy. Content in the catalog may contain technical inaccuracies, typographical errors and may be changed or updated without notice. Anderson may also make improvements and/or changes to the products and/or to the programs described in the content at any time without notice. Current sales drawings and specifications are available upon request. • Neither Anderson nor any party involved in creating, producing, or delivering this catalog shall be liable for any direct, incidental, consequential, indirect, or punitive damages arising out of your use of this catalog or any errors or omissions in its content. • All data subject to change without notice.

©2023 Anderson Power Products, Inc. All rights reserved. SB®, SBS®, SBE®, SBX®, Anderson Power Products®, are registered trademarks of Anderson Power Products, Inc. Anderson™, Anderson Power™, Anderson Power™ logo, and Your Best Connection™ are trademarks of Anderson Power Products, Inc.



HEADQUARTERS: Anderson Power Products®, 13 Pratts Junction Road, Sterling, MA 01564-2305 USA T: +1 978-422-3800 F: +1 978-422-0128 • **EUROPE:** Anderson Power Products® Ltd., Unit 3, Europa Court, Europa Boulevard, Westbrook, Warrington, Cheshire, WA5 7TN United Kingdom T: +44 (0) 1925 428390 F: +44 (0) 1925 520203 • **GERMANY:** IDEAL® Industries Germany GmbH, Esslinger Strasse 7, D – 70771 Leinfelden-Echterdingen, T: +49 (0) 711 – 997606666 • **ASIA / PACIFIC:** IDEAL® Anderson Asia Pacific Ltd., Unit 922-928 Topsail Plaza, 11 On Sum Street, Shatin N.T., Hong Kong T: +(852) 2636 0836 F: +(852) 2635 9036 • **INDIA:** IDEAL® INDUSTRIES India Private Limited, 229-230, SPAZEDGE, Tower B, Sector 47, Sohna Road, Gurgaon – 122018, Haryana, India T: +(91) 956-0075905 T: +(91) 124-4495101 • **CHINA:** IDEAL® Anderson Technologies (Shenzhen) Ltd., Block A8 Tantou Western Industrial Park, Songgang Baoan District, Shenzhen, PR. China 518105 T: +(86) 755 2768 2118 F: +(86) 755 2768 2218 • www.ideal-industries.in • www.andersonpower.com