

THIS DOCUMENT IS SUBJECT TO CHANGE WITHOUT NOTICE. IT IS CONFIDENTIAL AND A PROPERTY OF Amphenol LTW. DISCLOSURE TO THIRD PARTY HAS TO BE AUTHORIZED BY Amphenol LTW.

REV.	ECN NO.	DATE	SIGN	DESCRIPTION

ALTW
CONFIDENTIAL
2016-01-05
R&D DEPT.

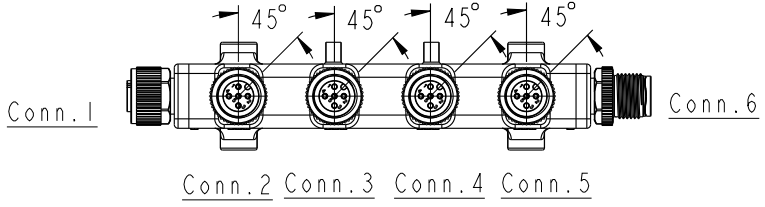
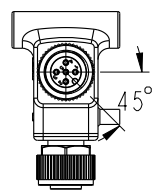
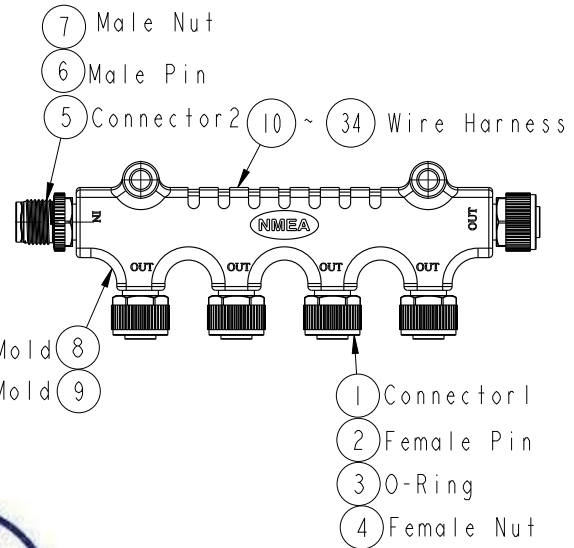
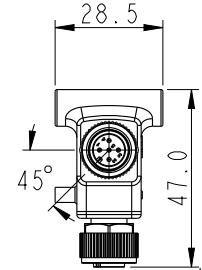
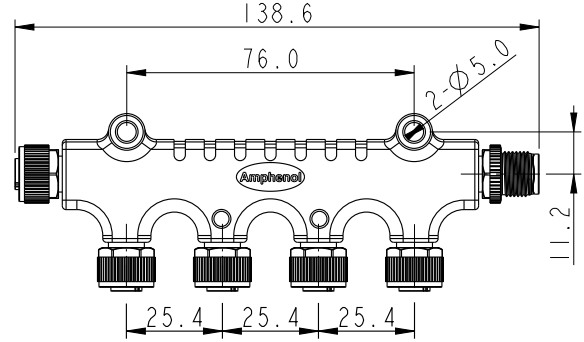
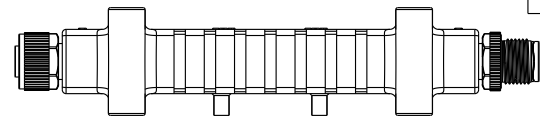

ALTW
DCC. DEPT.
CONFIDENTIAL
2016.03.31
ISSUED

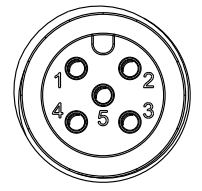

Conn. 1&2&3&4&5
Pin Assignments
Front View

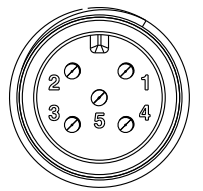

Conn. 6
Pin Assignments
Front View

Blue 藍	5	5	5	5	5	5
White 白	4	4	4	4	4	4
Black 黑	3	3	3	3	3	3
Red 紅	2	2	2	2	2	2
Green 綠	1	1	1	1	1	1
Wire Color	Conn.1	Conn.2	Conn.3	Conn.4	Conn.5	Conn.6
	Pin Out					

Note:

- * (Circled symbol) Important Dimension To Check.
- * Waterproof Rate: IP68
In 1 meter water within 24 hours
- * Connector: Pu, Black
- * Nut: PA66, Black
- * Pin: Copper Alloy, Gold Plated 30u"
- * Wire Harness: UL1061, 22AWG
- * Body: PU, Blue

UNIT: mm
TOLERANCE
±0.50mm

TITLE NMEA2000 Micro-C 4-WAY TEE			
SCALE 1:2	SIZE A4	SHEET 1 OF 1	
REV. A	WC-REV. A.1	QC: Inspection item	

Amphenol LTW
安費諾亮泰企業股份有限公司

ITEM NO. P-555555-FFFFF-S001	DRAWN BY Cary	DATE 2016-01-05
DWG NO. P-555555-FFFFF-S001	CHECKED BY Yulong	DATE 2016-01-05
CUSTOMER ALTW	APPROVED BY Jerry	DATE 2016-01-05